

# EVOLUTION™ SERIES FLOOR BOXES



Wiremold® Evolution™ Series Floor Boxes are the latest advancement in the most complete and innovative line of floor solutions in the industry.



## CODE REFERENCE

**cULus Listed**  
**Metallic Outlet Boxes:**  
 File E2961 Guide QCIT.  
 Meets Article 314.27(C) of NEC.

## Evolution™ Series Floor Box Components

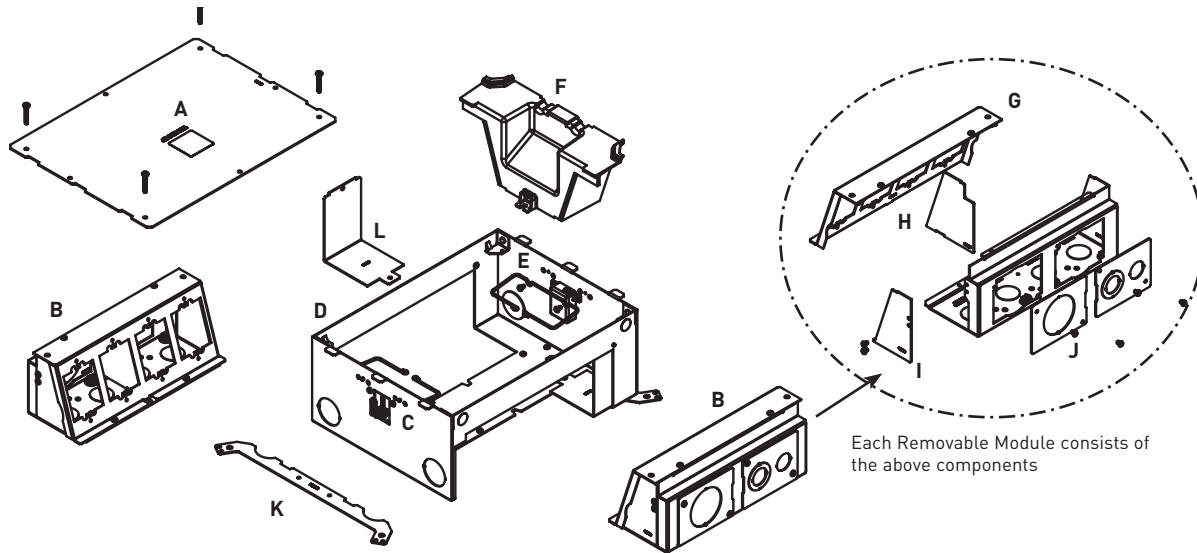

### KEY

- |   |                                       |
|---|---------------------------------------|
| A. Mud Cap (temporary construction cover) | G. Mounting Bracket                   |
| B. Removable Module                       | H. Divider (removable repositionable) |
| C. Toggle Clamp                           | I. End Cap                            |
| D. Box                                    | J. Back Knockout Plate                |
| E. Cable Guide                            | K. Concrete Level Leg                 |
| F. Tunnel                                 | L. "L" Bracket                        |

All items shown above are included with Evolution Series floor boxes.

### COLOR OPTIONS



Evolution Series Floor Box Covers are available in the following powder coated finishes: "BK" black, "GY" gray, "NK" nickel, "BS" brass, and "BZ" bronze.

**Custom color options are also available. Consult the factory for more information.**

# EVOLUTION™ SERIES FLOOR BOXES

## Evolution™ Series Floor Box Cover Plates & Accessories Ordering Information (continued)

### EFB610BTC

Surface Style Cover with Solid Lid

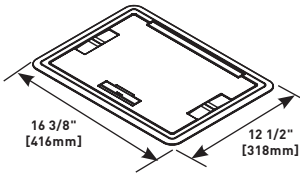

**EFB610BTCBK, EFB610BTCGY, EFB610BTCBS, EFB610BTCNK, EFB610BTCBZ**

Die cast aluminum cover assembly designed to be used on top of the floor covering. Available in the following powder coated finishes: black, gray, brass, nickel and bronze. For use on Evolution™ Series 6-, 8- and 10-gang floor boxes (EFB6, EFB8 and EFB10).

### EFB610CTR

Bare Concrete/Terrazzo Trim Ring

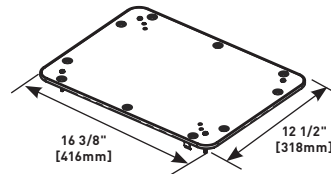

Nonmetallic ring for use with bare concrete and terrazzo floor applications.

**NOTE: Ring must be attached to the floor box before pouring concrete or terrazzo.**

### EFB610BT

Flush Style Cover with Solid Lid

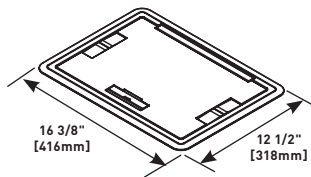

**EFB610BTBK, EFB610BTGY, EFB610BTBS, EFB610BTNK, EFB610BTBZ**

Die cast aluminum cover assembly designed to be used on top of floor covering. Available in the following powder coated finishes: black, gray, brass, nickel and bronze. For use on Evolution™ Series 6-, 8- and 10-gang floor boxes (EFB6, EFB8 and EFB10).

### EFB610-TS

Tile Shim

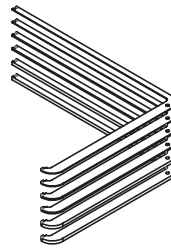

Used for floor coverings greater than 3/16" [4.7mm]. The EFB610-TS allows the finished cover assembly to be flush with the finished floor. Includes one (1) 1/16" [1.6mm], one (1) 1/8" [3.2mm] and one 1/4" [6.4mm] tile shims for 9/16" [14.3mm] of upward adjustment.

### EFB-Template

Floor Box Template

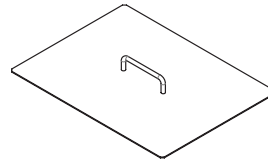

Designed to help mark out floor to insure a proper fit.

## Load Capacities for Evolution™ Series Floor Box Cover Assemblies

CATALOG NUMBERS	MAXIMUM LOAD IN POUNDS
EFB610BTC Series	1800
EFB610CTC Series	1800
EFB610BT Series	1800
EFB610CT Series	1800

**NOTE: Load applied through a 3" [76mm] mandrel in center of the cover. Loads above are static loads only and do not pertain to rolling loads.**



Evolution Series Floor Box Covers are available in powder coated finishes of [L to R] gray, nickel, bronze, brass and black.

# RESOURCE RFB® SERIES FLOOR BOXES

RFB4 Series

## Evolution Series Cover Assemblies for RFB4E & RFB4E-0G Floor Boxes Ordering Information

### 6CTC\* Surface Style Cover Assembly

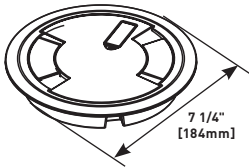

Die-cast aluminum cover assembly. Cover assembly is available in the following finishes: painted black (6CTCBK), painted gray (6CTCGY), nickel (6CTCNK), brass (6CTCBS), and bronze (6CTCBZ). 6CTC Series cover assemblies designed for use with 6STCP, 6STC, and 6STCPAV Poke-Thru Stem Assemblies.

### 6CT\* Flush Style Cover Assembly

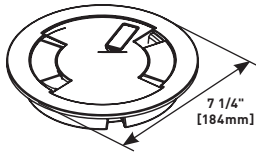

Die-cast aluminum cover assembly. Cover assembly is available in the following finishes: painted black (6CTBK), painted gray (6CTGY), nickel (6CTNK), brass (6CTBS), and bronze (6CTBZ). 6CT Series cover assemblies designed for use with 6STCP, 6STC, and 6STCPAV Poke-Thru Stem Assemblies. Includes one (1) 6TS Tile Shim.

\* Add suffix "TR" to the end of the part number to indicate tamper-resistant cover assembly. Tamper-resistant versions are secured with a single tamper-resistant screw.

### 6CFFTC Furniture Feed Cover Assembly

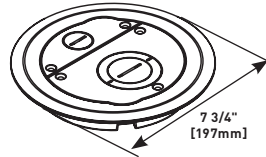

Surface style, die-cast aluminum cover assembly, with one (1) 3/4" trade size screw plug opening, and one (1) concentric 2"-1 1/4" trade size screw plug opening. Cover assembly is available in the following powder coated finishes: black (6CFFTCBK), gray (6CFFTCGY), nickel (6CFFTCNK), brass (6CFFTCBS), and bronze (6CFFTCBZ). 6CFFTC Series Cover Assemblies designed for use with 6STC Poke-Thru Stem Assembly. Includes one (1) 3/4" and one (1) 1" trade size conduit fittings and one (1) divider to separate devices.

### 6TS Tile Shim

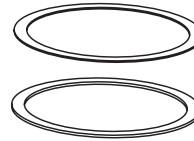

Used for floor coverings greater than 5/16" [7.9mm]. The 6TS will allow the top surface of the cover to be flush with the finished floor. Includes: six (6) 1/16" [1.6mm] thick shims. Up to a total of 3/8" [9.5mm] of adjustment.