



Compression Connectors for Copper Conductors

Narrow-Tongue Metric Lugs

Color-Keyed® narrow-tongue metric lugs feature a contained tongue width.

Our lugs have been specifically developed for applications with L.V. circuit breakers with reduced space requirements. The tongue width allows a quicker and easier installation.

Color-Keyed® narrow-tongue metric lugs are manufactured from electrolytic copper tube.

The specific design of the barrel and dimensions create the best combination of mechanical strength and electrical conductivity.

Color-Keyed® narrow-tongue metric lugs are annealed to guarantee optimum ductility and are electrolytically tin-plated to avoid oxidation.

The barrel is provided with an internal chamfer for easy insertion of the conductor. The length allows easy positioning of the dies for proper crimping.

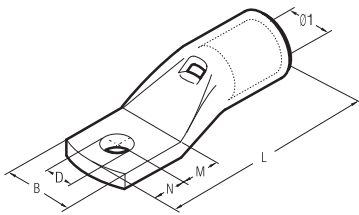

Cat. No.	Cond. Size Flexible (mm ²)	Stud (mm)	Dimensions (mm)						Std. Pkg.	6-Tons TBM62PCR-LI (Crimps)	14-Tons TBM14CR-LI (Crimps)
			Ø1	B	M	N	L	D			
MCCNT10M5	10	5	4.6	9.0	6.5	6.0	26.0	5.3	100	MCD10-6 (1)	MCD10-14 (1)
MCCNT16M5	16	5	5.8	9.0	6.5	6.0	29.0	5.3	100	MCD16-6 (1)	MCD16-14 (1)
MCCNT25M5	25	5	7.0	9.0	6.5	6.0	31.5	5.3	100	MCD25-6 (1)	MCD25-14 (1)
MCCNT35M6	35	6	8.9	11.5	8.0	7.0	36.5	6.4	100	MCD35-6 (2)	MCD35-14 (1)
MCCNT50M6	50	6	10.0	11.5	8.0	7.0	40.5	6.4	50	MCD50-6 (1)	MCD50-14 (1)
MCCNT70M6	70	6	11.3	11.5	8.0	7.0	44.0	6.4	50	MCD70-6 (2)	MCD70-14 (1)
MCCNT95M8	95	8	13.5	15.5	9.0	8.0	52.5	8.0	25	MCD95-6 (1)	MCD95-14 (1)
MCCNT120M8	120	8	15.2	19.0	14.0	9.0	60.0	8.4	25	MCD120-6 (2)	MCD120-14 (1)
MCCNT120M10		10	15.2	19.0	14.0	9.0	60.0	10.5	25	MCD120-6 (2)	MCD120-14 (1)
MCCNT150M8	150	8	16.7	19.0	18.0	9.0	70.0	8.4	25	MCD150-6 (3)	MCD150-14 (1)
MCCNT150M10		10	16.7	19.0	18.0	9.0	70.0	10.5	25	MCD150-6 (3)	MCD150-14 (1)
MCCNT185M10	185	10	19.2	24.5	18.0	9.0	77.0	10.5	25	MCD185-6 (3)	MCD185-14 (1)
MCCNT240M10	240	10	21.1	31.0	13.0	9.0	80.0	10.5	15	MCD240-6 (3)	MCD240-14 (1)
MCCNT240M12		12	21.1	31.0	16.0	12.0	86.0	13.2	15	MCD240-6 (3)	MCD240-14 (1)
MCCNT240M16		16	21.1	31.0	19.0	17.0	94.0	17.0	15	MCD240-6 (3)	MCD240-14 (1)
MCCNT300M12	300	12	23.7	31.0	16.0	12.0	95.0	13.2	10	-	MCD300-14 (3)