

Compression Connectors for Copper Conductors

One-Hole Metric Lugs (cont'd)

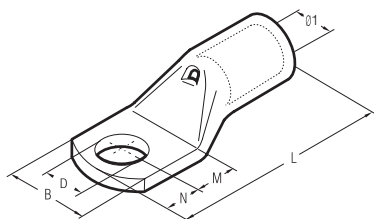

Cat. No.	Cond. Size mm ²		Stud (mm)	Dimensions (mm)						Std. Pkg.	6-Tons TBM62PCR-LI (Crimps)	14-Tons TBM14CR-LI (Crimps)	26-Tons TBM26MCC (Crimps)
	Low Stranded	Flexible		Ø1	B	M	N	L	D				
MCC120M6*	120	95 120	8	—	—	—	—	—	6.4	25	MCD120-6 (1)	MCD120-14 (1)	
MCC120M8			8	15.2	28.5	9.0	8.0	54.0	8.4	25			
MCC120M10			10	15.2	28.5	11.0	10.0	58.0	10.5	25			
MCC120M12			12	15.2	28.5	14.0	12.0	63.0	13.2	25			
MCC120M16			16	15.2	28.5	18.0	16.0	71.0	17.0	25			
MCC150M10	150	120 150	10	15.2	28.5	18.0	16.0	71.0	17.0	25	MCD150-6 (3)	MCD150-14 (1)	
MCC150M12			12	16.7	31.5	16.0	14.0	75.0	13.2	25			
MCC150M16			16	16.7	31.5	19.0	17.0	81.0	17.0	25			
MCC185M10	185	150 185	10	19.2	35.5	13.0	11.0	76.0	10.5	25	MCD185-6 (3)	MCD185-14 (1)	—
MCC185M12			12	19.2	35.5	16.0	14.0	82.0	13.2	25			
MCC185M16			16	19.2	35.5	19.0	17.0	88.0	17.0	15			
MCC240M10	240	185 240	10	21.1	39.0	13.0	11.0	82.0	10.5	15	MCD240-6 (3)	MCD240-14 (2)	
MCC240M12			12	21.1	39.0	16.0	14.0	88.0	13.2	15			
MCC240M16			16	21.1	39.0	19.0	17.0	94.0	17.0	15			
MCC300M10	300	240	10	23.7	44.0	13.0	11.0	96.0	10.5	10		MCD300-14 (3)	
MCC300M12			12	23.7	44.0	16.0	14.0	99.0	13.2	10			
MCC300M16			16	23.7	44.0	19.0	19.0	10.0	17.0	10			
MCC400M10*	400	300	10	27.0	51.0	22.0	19.0	113.0	13.2	5		MCD400-14 (3)	MCD400-26 (2)
MCC400M12			12	27.0	51.0	22.0	19.0	113.0	13.2	5			
MCC400M16			16	27.0	51.0	22.0	19.0	113.0	17.0	5			
MCC500M10*	500	400	10	—	—	—	—	—	13.2	5	—		MCD500-26 (2)
MCC500M12*			12	—	—	—	—	—	17.0	5			
MCC500M16			16	30.3	56.5	22.0	19.0	117.0	17.0	5			
MCC630M16	630	500	16	33.4	61.6	22.0	19.0	128.0	17.0	6		—	MCD630-26 (2)
MCC630M20			20	33.4	61.6	24.0	23.0	134.0	21.0	6			
MCC800M16	800	630	16	38.0	72.0	24.0	19.0	141.0	17.0	3		—	—
MCC800M20			20	38.0	72.0	24.0	23.0	145.0	21.0	3			
MCC1000M16	1000	800	16	44.0	80.0	24.0	19.0	158.0	17.0	2		—	—
MCC1000M20			20	44.0	80.0	24.0	23.0	162.0	21.0	2			

* UL not applicable.