

## Fittings and Brackets

### Angular Fittings

#### AB225

AB225HDGC  
AB225EG  
AB225  
AB225SS6

Wt./C 58 lb.

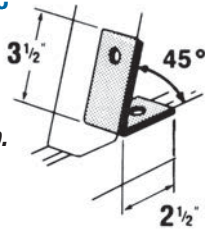

Other angles available.  
Contact your Regional Sales Office.

#### AB226

AB226HDGC  
AB226SS6

Wt./C 119 lb.

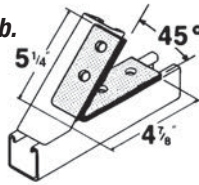

Other angles available.  
Contact your Regional Sales Office.

#### AB227

AB227HDGC  
AB227EG  
AB227  
AB227SS6

Wt./C 58 lb.

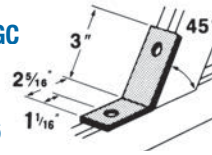

Other angles available.  
Contact your Regional Sales Office.

#### AB228

AB228HDGC  
AB228SS6C

Wt./C 69 lb.

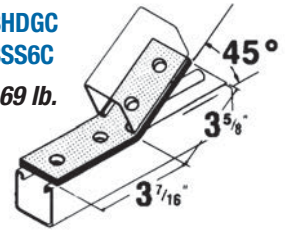

Other angles available.  
Contact your Regional Sales Office.

#### AB231

AB231EG

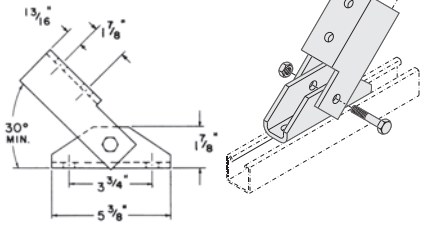

#### AB232

AB232EG

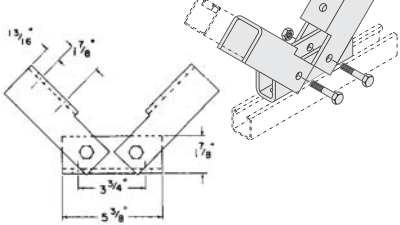

#### AB239

\*Finishes

• HDGC • EG • GoldGalv®

Cat. No.	A (in.)	B (in.)	Wt./C lb.
AB239-1*	7-13/16	8-1/2	148
AB239-2*	13-3/4	17	255
AB239-3*	19-3/4	25-1/2	363

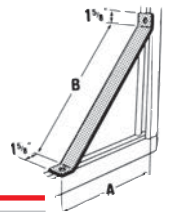

### "Z" Shape Fittings

#### A209

A209HDGC  
A209EG  
A209  
A209SS6

Wt./C 55 lb.

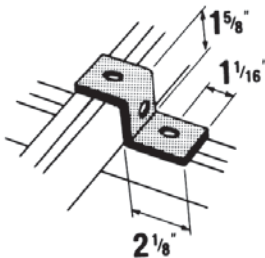

For attaching A and AR Series channel.

#### B209

B209HDGC  
B209EG  
B209

Wt./C 43 lb.

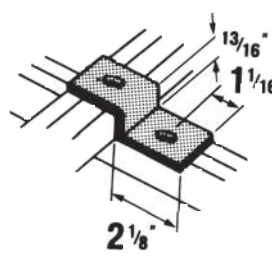

For attaching B and BR Series channel.

#### C209

C209

Wt./C 49 lb.

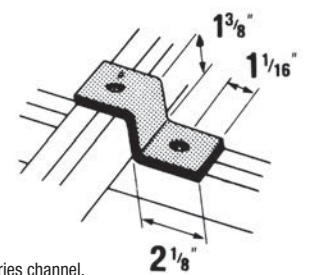

For attaching C Series channel.

#### D209

Wt./C 45 lb.

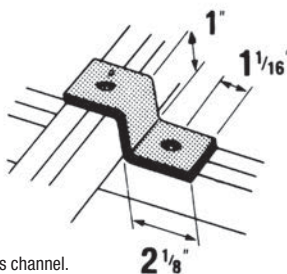

For attaching D Series channel.

#### CZ209

For attaching H Series  
and A back to back.

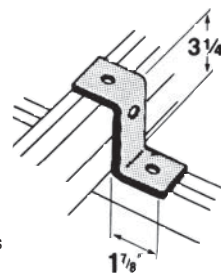

#### EZ209

EZ209HDGC  
EZ209EG  
EZ209  
EZ209SS6

For attaching E Series channel.

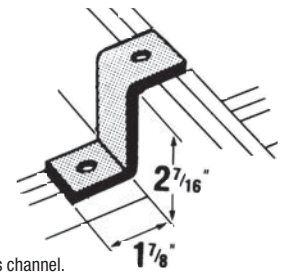

Standard Dimensions	Value
Hole Spacing	→ 13/16 in. From End
Hole Spacing	→ 1-7/8 in. Centers
Hole Size	→ 9/16 in. Diam.
Material	→ 1-5/8 in. Width
Material	→ 1/4 in. Thick

Materials	Value
HDG(C)	→ Hot-Dipped Galvanized
EG(C)	→ ElectroGalvanized
(No suffix)	→ GoldGalv®
SS6(C)	→ Stainless Steel 316