

Aluminum Lugs

Two-Hole CSA Die Lugs

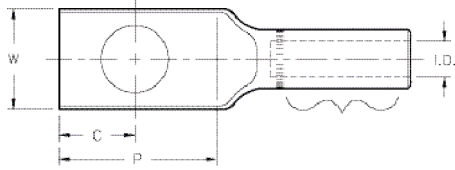

Marking Information _____
 Cat. No. _____
 Wire Size _____
 Die Size _____

of crimps and locations to be determined according to connector

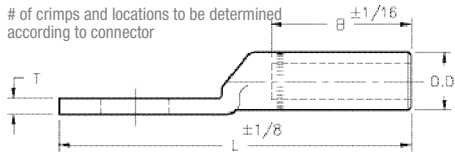

- Use with aluminum and copper conductors
- Provides high strength and high-conductivity
- Prevents oxidation and keeps out moisture
- Easy identification
- Meet or exceed ANSI C119.4 specifications

Cat. No.	Wire Size	CSA Die	O.D.	I.D.	Dimensions				
					L	B	P	W	T
GLE 2 N	2 str.—Compr—CPT	22	0.635	0.350	5.29	1.50	3.13	0.88	0.20
GLE 1/0 N	1/0 str.—Compr—CPT		0.640	0.420	5.25	1.50	3.13	0.87	0.21
GLE 2/0 N	2/0 str.—Compr—CPT	24	0.840	0.503	5.29	1.50	3.13	1.04	0.28
GLE 3/0 N	3/0 str.—Compr—CPT			0.547	5.38	1.50	3.13	1.14	0.28
GLE 4/0 N	4/0 str.—Compr—CPT	24-6T		0.594	5.38	1.50	3.13	1.14	0.28
GLE 250 N	250 str.—Compr—CPT	26	1.000	0.620	6.00	2.00	3.13	1.25	0.36
GLE 300 N	300 str.—Compr—CPT	26-12T		0.670	6.00	2.00	3.13	1.25	0.36
GLE 350 N	350 str.—Compr—CPT	28	1.189	0.730	6.00	2.00	3.13	1.25	0.37
GLE 500 N	500 str.—Compr—CPT	28-12T	1.187	0.836	6.38	2.25	3.13	1.25	0.37
GLE 500 N-30	500 str.—Compr—CPT	30	1.438	0.880	6.38	2.50	3.13	1.75	0.40
GLE 750 N	750 str.—Compr—CPT			1.031	7.50	3.00	3.13	1.75	0.40

Finish: Tin-plated optional, use suffix "-TN".

Material: E.C. Grade Aluminum.

Connector bores are coated with HM 53 a oxide inhibiting compound and capped.

Mounting holes sized for 1/2 in. bolts (9/16 hole size).

Optional suffix "-38" for 3/8 bolts (13/32 hole size).