

Copper Mechanical Connectors

For stranded, solid, flexible and other types of cables.

LOCKTITE® Tandem-Type Two-Hole NEMA-Drilled Lugs

- Each lug takes a range of wire sizes
- Bolt holes and spacings listed are standard
- For use with code copper conductor (600V)



CAT. NO.	CABLE SIZE	DIMENSIONS (IN.)							
		G	A	B	C	D	J	F	H
32007TL	4 to 1	3/8	3 3/16	2	3/4	7/32	2 9/32	7/16	1
32009TL	1 to 2/0	1/2	4 15/16	3	1	1/4	1 3/32	9/16	1 3/4
32011TL	2/0 to 4/0	1/2	5 5/8	3	1	9/32	1 5/16	9/16	1 3/4
32013TL	4/0 to 300	1/2	5 5/8	3	1 1/16	5/16	1 9/16	9/16	1 3/4
32015TL	300 to 500	1/2	6 11/32	3 1/2	1 3/8	1 1/32	—	5/8	1 3/4
32017TL	500 to 750	1/2	6 23/32	3 1/2	1 3/4	1 3/32	2 1/8	5/8	1 3/4

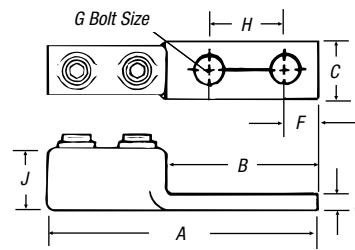

For easy installation in hard-to-reach places.

LOCKTITE® Ground Bus Taps for 1/4" Copper Bus Bar

- Eliminate the need to drill holes in the ground bus
- Can be placed quickly at any location
- Install with only a key wrench
- Standard LOCKTITE® lug grip securely holds tapping cable
- For use with code copper conductor (600V)



CAT. NO.	WIRE SIZE (IN.)	DIMENSIONS (IN.)		
		A	B	BUS THICKNESS
31207	8 to 4	2 1/4	1 3/4	1/4
31208	4 to 1	2 5/16	1 3/4	1/4
31209	1 to 2/0	2 3/4	1 3/4	1/4
31210	2/0 to 4/0	2 3/4	1 3/4	1/4
31211	4/0 to 300	2 3/4	1 3/4	1/4
31212	300 to 500	3	1 3/4	1/4

For torque requirements, see page F-188.

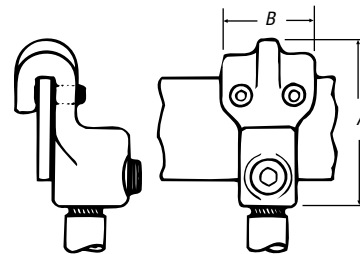

LOCKTITE® Pigtail Connectors

- For use with code copper conductor (600V)



CAT. NO.	SIZE	CABLE FIG.	DIMENSIONS (IN.)	
			A	J
31305	10 to 8	A	1/2	1 1/32
31307	8 to 6	A	3/4	2 7/32
31309	6 to 4	B	7/8	1 1/32
31311	4 to 2	B	1 1/16	1 1/4
31313	1 to 2/0	B	1 3/16	1 1/2
31315	2/0 to 4/0	B	1 1/16	1 29/32

For torque requirements, see page F-188.

Note: To order with hex head screws (available on all except 10-8 code size), add prefix H to catalog number.

