

Copper Mechanical Connectors

All the outstanding LOCKTITE® lug features — plus two-bolt capacity.

LOCKTITE® One-Hole 90° Upright Lugs



- For use with code copper conductor (600V)



CAT. NO.	CABLE SIZE	DIMENSIONS (IN.)						
		G	A	B	C	D	J	F
31005-UAL ¹	8 to 4	¼	1½	¾	½	⅙	½	⅝
31007-UAL	4 to 1	¼	1 ² / ₃₂	1 ³ / ₁₆	⅝	7/32	1 ³ / ₁₆	1 ¹ / ₃₂
31009-UAL	1 to 2/0	¾	2 ⁷ / ₃₂	1	1 ³ / ₁₆	¼	1 ⁵ / ₁₆	7/16
31011-UAL	2/0 to 4/0	¾	2½	1¼	1	9/32	1½	1 ⁷ / ₃₂

¹With Filister Head Screw. All others, hex head screws.
Bolt holes and spacings listed are standard, but lugs with blank tongues can be furnished.

LOCKTITE® Two-Hole Lugs

- Easy installation
- High conductivity
- Wide cable range
- Long tongue adapted for two bolts
- For use with code copper conductor (600V)

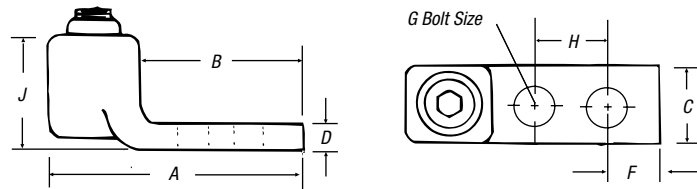

CAT. NO.	CABLE SIZE	DIMENSIONS (IN.)							
		G	A	B	C	D	J	F	H
32003 ¹	14 to 8	¼	1 ¹¹ / ₁₆	1¼	½	⅙	15/32	9/32	5/8
32005 ¹	8 to 4	¼	1¾	1¼	½	⅙	1 ⁷ / ₃₂	9/32	5/8
32007	4 to 1	¼	2¼	1 ⁷ / ₁₆	⅝	7/32	7/8	9/32	¾
32009	1 to 2/0	¾	2½	1 ¹⁵ / ₁₆	1 ³ / ₁₆	¼	1 ³ / ₃₂	7/16	1
32011	2/0 to 4/0	¾	3½	2	1	9/32	1 ⁹ / ₁₆	7/16	1
32013	4/0 to 300	¾	3¾	2½	1 ¹ / ₁₆	7/16	1 ¹ / ₁₆	7/16	1
32015	300 to 500	¾	3½	2½	1 ³ / ₈	1 ¹ / ₃₂	1 ²⁷ / ₃₂	7/16	1
32017	500 to 750	½	4 ¹⁹ / ₃₂	3	1¾	1 ³ / ₃₂	2½	9/16	1½
32019	750 to 1,000	½	4 ²⁷ / ₃₂	3	1¾	1 ⁵ / ₃₂	2 ¹ / ₃₂	9/16	1½

¹With Filister Head Screw. All others, hex head screws.
For torque requirements, see page F-188.

LOCKTITE® Two-Hole NEMA-Drilled Lugs

- Furnished with bolt holes and spacings to fit equipment with NEMA-type connector mounting pads
- For use with code copper conductor (600V)

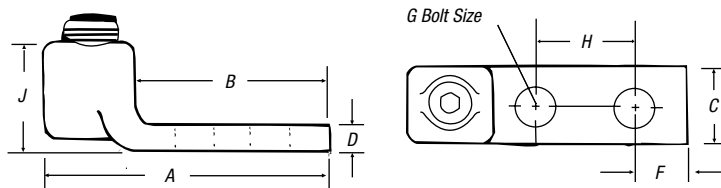

CAT. NO.	CABLE SIZE	DIMENSIONS (IN.)							
		G	A	B	C	D	J	F	H
32207	4 to 1	¾	2 ¹³ / ₁₆	2	¾	7/32	7/8	7/16	1
32209	1 to 2/0	½	3 ¹⁵ / ₁₆	3	1	¼	1 ¹ / ₁₆	9/16	1¼
32211	2/0 to 4/0	½	4½	3	1	9/32	1 ⁹ / ₃₂	9/16	1¼
32213	4/0 to 300	½	4 ⁹ / ₁₆	3	1 ¹ / ₁₆	7/16	1 ¹⁹ / ₃₂	9/16	1¾
32215	300 to 500	½	4¾	3½	1 ³ / ₈	1 ¹ / ₃₂	1 ¹⁹ / ₁₆	9/16	1¾
32217	500 to 750	½	5 ³ / ₃₂	3½	1¾	1 ³ / ₃₂	2½	9/16	1¾
32219	750 to 1,000	½	5¼	3½	3	1 ⁵ / ₃₂	2½	9/16	1¾

For torque requirements, see page F-188.