

Fork Terminals

- Fork terminals enable easy installation because the mounting screw does not have to be completely removed
- Brazed-seam barrel is serrated for high pull-out value. Terminal is high-conductivity electrolytic copper, electro-tin plated.
- Insulation is color coded
- Vinyl-insulated fork terminals have extra-long PVC insulation sleeve for protection and stress relief at wire's flex point
- Suffix "X" indicates an expanded insulation support, meaning a wider wire entry to accommodate heavy wall insulation

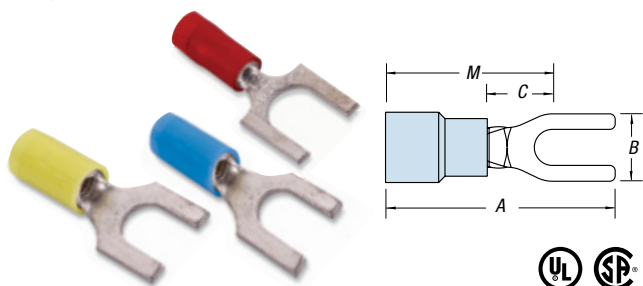

Nylon-Insulated Forks



CAT. NO.	PKG. QTY.	WIRE RANGE	MAX. INS.	BOLT HOLE	REC. TOOL	DIMENSIONS				STOCK THICK.	
						A	B	C	M		
RA18-6F	100	22-16	.136	#6	ERG4001	.83	.25	.25	.71	.02	
RA1103	1,000	22-16	.136	#6		.83	.25	.25	.71		
RA18-8F	100	22-16	.136	#8		.86	.31	.25	.71		
RA1123	1,000	22-16	.136	#8		.86	.31	.25	.71		
RA18-10F	100	22-16	.136	#10		.86	.31	.25	.71		
RA1153	1,000	22-16	.136	#10		.86	.31	.25	.71		
RA18-14F	100	22-16	.136	1/4"		.95	.44	.31	.70		
RA1163	1,000	22-16	.136	1/4"		.95	.44	.31	.70		
RB14-6F	100	18-14	.162	#6		.87	.31	.25	.71		.03
RB1113	1,000	18-14	.162	#6		.87	.31	.25	.71		
RB14-8F	100	18-14	.162	#8	.87	.31	.25	.71			
RB1123	1,000	18-14	.162	#8	.87	.31	.25	.71			
RB14-10F	100	18-14	.162	#10	.87	.38	.25	.71			
RB1153	1,000	18-14	.162	#10	.87	.38	.25	.71			
RB14-14F	100	18-14	.162	1/4"	.95	.44	.28	.74			
RB1163	1,000	18-14	.162	1/4"	.95	.44	.28	.74			
RB1103	1,000	18-14	.162	#6	.74	.28	.16	.60			
RB1124	1,000	18-14	.190	#8	.95	.31	.25	.79			
RB1154	1,000	18-14	.190	#10	.95	.31	.25	.79			
RC10-6F	50	12-10	.210	#6	ERG4001	.97	.31	.27	.81	.04	
RC1113	500	12-10	.210	#6		.97	.31	.27	.81		
RC10-8F	50	12-10	.210	#8		1.00	.37	.27	.81		
RC1123	500	12-10	.210	#8		1.00	.37	.27	.81		
RC10-10F	50	12-10	.210	#10		1.00	.37	.27	.81		
RC1153	500	12-10	.210	#10		1.00	.37	.27	.81		
RC10-14F	50	12-10	.210	1/4"		1.12	.50	.27	.86		
RC1163	500	12-10	.210	1/4"		1.12	.50	.27	.86		
RC1124	1,000	12-10	.250	#8		1.10	.37	.27	.91		
RC1154	1,000	12-10	.250	#10		1.10	.37	.27	.91		
RC10-6FL	50	12-10	.210	#6		.97	.31	.27	.81		.04
RC2203	500	12-10	.210	#6		.97	.31	.27	.81		
RC2204	1,000	12-10	.250	#6		1.07	.31	.27	.91		
RC10-8FL	50	12-10	.210	#8		1.00	.37	.27	.81		
RC2213	500	12-10	.210	#8		1.00	.37	.27	.81		
RC10-10FL	50	12-10	.210	#10	1.00	.37	.27	.81			
RC2223	500	12-10	.210	#10	1.00	.37	.27	.81			
RC2224	1,000	12-10	.250	#10	1.10	.37	.27	.91			
RC10-14FL	50	12-10	.210	1/4"	1.12	.50	.32	.86			
RC2233	500	12-10	.210	1/4"	1.12	.50	.32	.86			

Nylon-Insulated Locking Forks

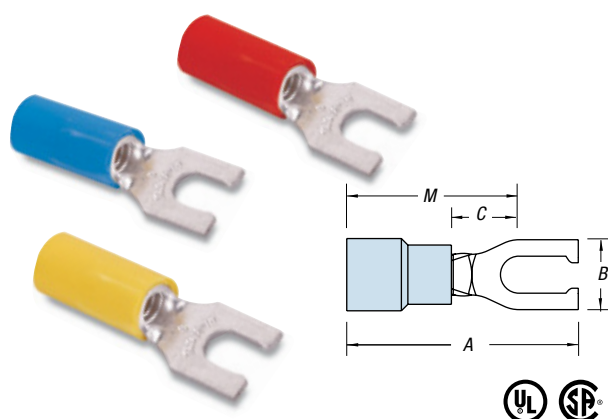

CAT. NO.	PKG. QTY.	WIRE RANGE	MAX. INS.	BOLT HOLE	REC. TOOL	DIMENSIONS				STOCK THICK.	
						A	B	C	M		
RA18-6FL	100	22-16	.136	#6	ERG4001	.86	.25	.25	.71	.02	
RA2213	1,000	22-16	.136	#6		.86	.25	.25	.71		
RA18-8FL	100	22-16	.136	#8		.86	.29	.25	.71		
RA2243	1,000	22-16	.136	#8		.86	.29	.25	.71		
RA18-10FL	100	22-16	.136	#10		.86	.29	.25	.71		
RA2253	1,000	22-16	.136	#10		.86	.29	.25	.71		
RB14-6FL	100	18-14	.162	#6		.87	.25	.25	.71		.03
RB2213	1,000	18-14	.162	#6		.87	.25	.25	.71		
RB2214	1,000	18-14	.190	#6		.95	.25	.25	.79		
RB14-8FL	100	18-14	.162	#8		.87	.29	.25	.71		
RB2233	1,000	18-14	.162	#8	.87	.29	.25	.71			
RB14-10FL	100	18-14	.162	#10	.87	.29	.25	.71			
RB2253	1,000	18-14	.162	#10	.87	.29	.25	.71			
RB2254	1,000	18-14	.190	#10	.95	.29	.25	.71			
RC10-6FL	50	12-10	.210	#6	.97	.31	.27	.81	.04		
RC2203	500	12-10	.210	#6	.97	.31	.27	.81			
RC2204	1,000	12-10	.250	#6	1.07	.31	.27	.91			
RC10-8FL	50	12-10	.210	#8	1.00	.37	.27	.81			
RC2213	500	12-10	.210	#8	1.00	.37	.27	.81			
RC10-10FL	50	12-10	.210	#10	1.00	.37	.27	.81			
RC2223	500	12-10	.210	#10	1.00	.37	.27	.81			
RC2224	1,000	12-10	.250	#10	1.10	.37	.27	.91			
RC10-14FL	50	12-10	.210	1/4"	1.12	.50	.32	.86			
RC2233	500	12-10	.210	1/4"	1.12	.50	.32	.86			

Fork Terminals and Pin Terminals

Non-Insulated Locking Fork Terminals

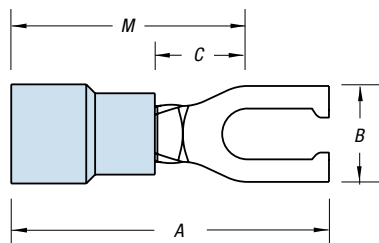

CAT. NO.	PKG. QTY.	WIRE RANGE	BOLT HOLE	REC. TOOL	DIMENSIONS				STOCK THICK.
					A	B	C	M	
A18-6FL	100	22-16	#6	ERG4002	.75	.25	.27	.59	.02
A221	1,000	22-16	#6		.75	.25	.27	.59	
A18-8FL	100	22-16	#8		.75	.29	.27	.59	
A224	1,000	22-16	#8		.75	.29	.27	.59	
A18-10FL	100	22-16	#10		.75	.29	.27	.59	
A225	1,000	22-16	#10	.75	.29	.27	.59	.03	
B14-6FL	100	18-14	#6	ERG4002	.75	.25	.27		.59
B220	1,000	18-14	#6		.75	.25	.27		.59
B14-8FL	100	18-14	#8		.75	.29	.27		.59
B223	1,000	18-14	#8		.75	.29	.27		.59
B14-10FL	100	18-14	#10		.75	.29	.27	.59	
B225	1,000	18-14	#10	.75	.29	.27	.59	.04	
C10-6FL	50	12-10	#6	ERG4002 ERG4005	.85	.31	.27		.66
C220-TB	500	12-10	#6		.85	.31	.27		.66
C10-8FL	50	12-10	#8		.85	.37	.27		.66
C221	500	12-10	#8		.85	.37	.27		.66
C10-10FL	50	12-10	#10		.85	.37	.27	.66	
C222	500	12-10	#10	.85	.37	.27	.66	.04	
C10-14FL	50	12-10	¼"	.85	.49	.27	.66		

Pin Terminals

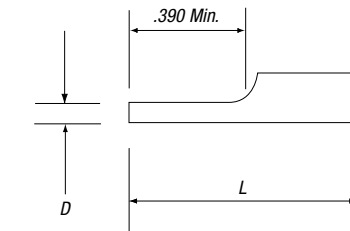

Non-Insulated Pin Terminal

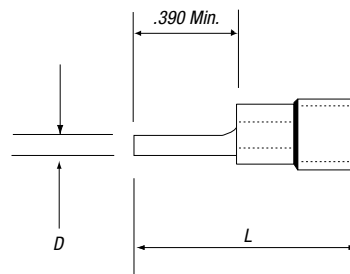

Insulated Pin Terminal



CAT. NO.	PKG. QTY.	WIRE RANGE	D (DIA.)	L	REC. TOOLS	STOCK THICK.
Non-Insulated						
A47PT	1,000	22-18	.075	.63	ERG4002	.02
B47PT	1,000	16-14	.075	.63		.03
C55PT	500	12-10	.106	.76		.04
Vinyl						
18RA-47PT	100	22-18	.075	.85	ERG4001	.02
RA47PT	1,000	22-18	.075	.85		.03
14RB-47PT	100	16-14	.075	.87		
RB47PT	1,000	16-14	.075	.87		
10RC-55PT	50	12-10	.106	1.04		
RC55PT	500	12-10	.106	1.04		
Nylon						
RA18-47PT	100	22-18	.075	.85	ERG4001	.02
RA147PT	1,000	22-18	.075	.85		.03
RB14-47PT	100	16-14	.075	.87		
RB147PT	1,000	16-14	.075	.87		
RC10-55PT	50	12-10	.106	1.04		
RC155PT	500	12-10	.106	1.04		