

## Copper Mechanical Conductors

High pull-out strength and low resistance.

### LOCKTITE® Cone Screw Lugs

- Conically shaped screw compresses copper conductor so each strand is forced to carry its share of the load
- Exerts equal pressure on each conductor strand
- For use with code copper conductor (600V)

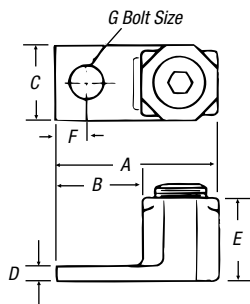

CAT. NO.	WIRE RANGE	DIMENSIONS (IN.)								TORQUE (IN.-LBS.)
		G	A	B	C	D	E	F		
71003	14-8	#10	1 <sup>3</sup> / <sub>16</sub>	7 <sup>1</sup> / <sub>16</sub>	3 <sup>1</sup> / <sub>8</sub>	3 <sup>1</sup> / <sub>2</sub>	3 <sup>1</sup> / <sub>8</sub>	3 <sup>1</sup> / <sub>16</sub>	20*	
71005	14-4	1 <sup>1</sup> / <sub>4</sub>	1 <sup>1</sup> / <sub>32</sub>	5 <sup>1</sup> / <sub>8</sub>	9 <sup>1</sup> / <sub>16</sub>	1 <sup>1</sup> / <sub>8</sub>	1 <sup>9</sup> / <sub>32</sub>	9 <sup>1</sup> / <sub>32</sub>	35*	
71010	4-2/0	3 <sup>1</sup> / <sub>8</sub>	1 <sup>21</sup> / <sub>32</sub>	2 <sup>7</sup> / <sub>32</sub>	2 <sup>3</sup> / <sub>32</sub>	3 <sup>1</sup> / <sub>16</sub>	2 <sup>5</sup> / <sub>32</sub>	3 <sup>1</sup> / <sub>8</sub>	150	
71014	2-4/0	3 <sup>1</sup> / <sub>8</sub>	1 <sup>1</sup> / <sub>8</sub>	2 <sup>9</sup> / <sub>32</sub>	1 <sup>5</sup> / <sub>16</sub>	3 <sup>1</sup> / <sub>16</sub>	3 <sup>1</sup> / <sub>32</sub>	3 <sup>1</sup> / <sub>8</sub>	200	
71015	1-250	3 <sup>1</sup> / <sub>8</sub>	2 <sup>1</sup> / <sub>32</sub>	2 <sup>9</sup> / <sub>32</sub>	1	7 <sup>1</sup> / <sub>32</sub>	1	3 <sup>1</sup> / <sub>8</sub>	250	
71020	2/0-500	1 <sup>1</sup> / <sub>2</sub>	2 <sup>3</sup> / <sub>4</sub>	1 <sup>1</sup> / <sub>4</sub>	1 <sup>1</sup> / <sub>2</sub>	3 <sup>1</sup> / <sub>2</sub>	1 <sup>15</sup> / <sub>32</sub>	9 <sup>1</sup> / <sub>16</sub>	300	

Add suffix G to lug Cat. No. 71003, 71005, 71010 and 71014 for lug with green screw for grounding identification.

UL File No. E-9609.

\*Indicates screwdriver torque; all others indicate torque wrench.

The most economical, easiest to install, approved connector for large to small branch taps.

### HINJON Junior Tee-Parallel Taps

- All-around-grip jaws
- Automatically adjusts to size of main and branch
- Fast, simple installation with just a screwdriver or pliers
- Fitting can be easily taped

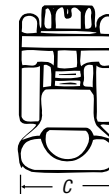
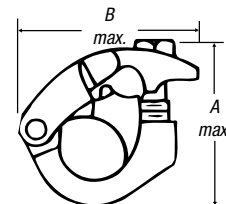

#### T&B Recommended Tightening Torque

SIZE OF CONDUCTOR RANGES	WRENCH TORQUE IN.-LBS.	SCREW DRIVER TORQUE IN.-LBS.
14 to 8	20	20
14 to 4	35	35
4 to 2/0	150	—
2 to 4/0	200	—
1 to 250	250	—
2/0 to 500	300	—

CAT. NO.	CABLE SIZE		DIMENSIONS (IN.)		
	MAIN	BRANCH	A	B	C
35107	8 to 4	14 to 8	1 <sup>1</sup> / <sub>16</sub>	7 <sup>1</sup> / <sub>8</sub>	5 <sup>1</sup> / <sub>8</sub>
35109	4 to 1/0	14 to 4	1 <sup>1</sup> / <sub>4</sub>	1	1 <sup>1</sup> / <sub>16</sub>
35111	1/0 to 4/0	14 to 4	1 <sup>3</sup> / <sub>4</sub>	1 <sup>3</sup> / <sub>8</sub>	2 <sup>7</sup> / <sub>32</sub>
35112	1/0 to 4/0	8 to 1	1 <sup>1</sup> / <sub>8</sub>	1 <sup>3</sup> / <sub>16</sub>	2 <sup>7</sup> / <sub>32</sub>
35115	300 to 500	14 to 4	1 <sup>1</sup> / <sub>2</sub>	1 <sup>15</sup> / <sub>16</sub>	1