

Conduit, Cable and Pipe Supports

Lightweight, non-breakable and inexpensive!

Kindorf® TPE Cable Insulator Clamps

Offer a less expensive, lighter weight and non-breakable alternative to porcelain for cable support, and they won't rot like maple clamps. The one-piece thermoplastic elastomer (TPE) insulator is flame-retardant, UV-resistant and chemical-resistant. A tapered flange isolates and protects cable. Available sizes accommodate cables from 3/8" to 4 1/2" O.D. and fit all Kindorf® channels as well as all 1 1/2" channel systems.



CAT. NO.	HOLE DIA. (IN.)	CLAMP SIZE (IN.)	DIM. A (IN.)	DIM. B&R (IN.)	TOTAL HEIGHT (IN.)
C755 1ATP	3/8	1 1/8	1.12	.56	1.82
C-755-1B-TP	1/2	1 1/8	1.12	.56	1.82
C-755-1C-TP	5/8	1 1/8	1.12	.56	1.82
C-755-2 TP	3/4	1 1/8	1.62	.81	2.34
C-755-2A-TP	7/8	1 1/8	1.62	.81	2.34
C-755-2B-TP	1	1 1/8	1.62	.81	2.34
C-755-2C-TP	1 1/8	1 1/8	1.62	.81	2.34
C-755-3 TP	1 1/4	2 1/8	2.12	1.06	2.86
C-755-3A-TP	1 3/8	2 1/8	2.12	1.06	2.86
C-755-3B-TP	1 1/2	2 1/8	2.12	1.06	2.86
C-755-3C-TP	1 5/8	2 1/8	2.12	1.06	2.86
C-755-4 TP	1 3/4	2 3/8	2.62	1.31	3.5
C-755-4A-TP	1 7/8	2 3/8	2.62	1.31	3.5
C-755-4B-TP	2	2 3/8	2.62	1.31	3.5
C-755-4C-TP	2 1/8	2 3/8	2.62	1.31	3.5
C-755-5 TP	2 1/4	3 1/8	3.12	1.56	4.05
C-755-5A-TP	2 3/8	3 1/8	3.12	1.56	4.05
C-755-5B-TP	2 1/2	3 1/8	3.12	1.56	4.05
C-755-5C-TP	2 5/8	3 1/8	3.12	1.56	4.05
C-755-6 TP	2 3/4	3 3/8	3.62	1.81	4.75
C-755-6A-TP	2 7/8	3 3/8	3.62	1.81	4.75
C-755-6B-TP	3	3 3/8	3.62	1.81	4.75
C-755-6C-TP	3 1/8	3 3/8	3.62	1.81	4.75
C-755-7 TP	3 1/4	4 1/8	4.12	2.06	5.125
C-755-7A-TP	3 3/8	4 1/8	4.12	2.06	5.125
C-755-7B-TP	3 1/2	4 1/8	4.12	2.06	5.125
C-755-7C-TP	3 5/8	4 1/8	4.12	2.06	5.125
C-755-8 TP	3 3/4	4 3/8	4.62	2.31	5.54
C-755-8A-TP	3 7/8	4 3/8	4.62	2.31	5.54
C-755-8B-TP	4	4 3/8	4.62	2.31	5.54
C-755-8C-TP	4 1/8	4 3/8	4.62	2.31	5.54
C-755-8D-TP	4 1/4	5	5	2.5	5.92
C-755-8E-TP	4 3/8	5	5	2.5	5.92
C-755-8F-TP	4 1/2	5	5	2.5	5.92

- Tapered flange isolates and protects cable
- Flame retardant
- UV resistant
- Exceptional chemical resistance
- Ideal for commercial and industrial applications
- Thermoplastic elastomer (TPE) insulator
- Electro-galvanized finish steel clamp with Everdur nut and bolt
- Dielectric strength of 640V per mil
- Sizes to hold cables 3/8" to 4 1/2" O.D.
- Fits all channel sizes
- UL® Listed

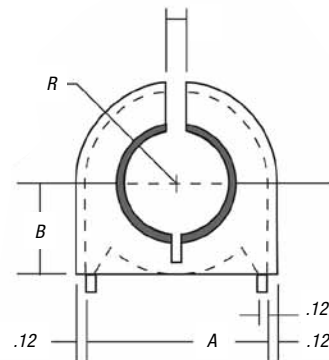

Conduit, Cable and Pipe Supports

C-755 Porcelain Insulator Clamp

Dry-process white-glaze porcelain insulators assembled in pairs to accept cables from 3/8" through 4 1/2" O.D. C-105 clamp with bronze slotted hex head screw and nut furnished. Fits all Kindorf® channels.

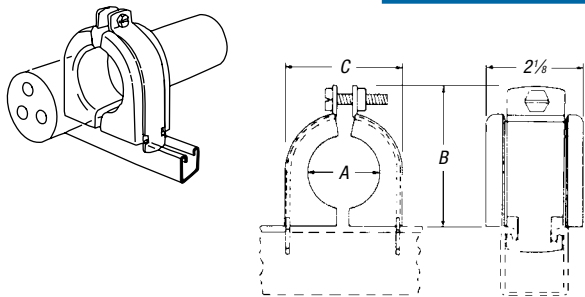

CAT. NO.	DIMENSIONS (IN.)			STRAP C-105 (IN.)	WT. IN LBS./C
	A	B	C		
C-755-1A	3/8	2 1/16	1 9/16	1	50
C-755-1B	1/2	2 1/16	1 9/16	1	50
C-755-1C	5/8	2 1/16	1 9/16	1	50
C-755-2	3/4	2 3/32	2 3/32	1 1/2	91
C-755-2A	7/8	2 3/32	2 3/32	1 1/2	90
C-755-2B	1	2 3/32	2 3/32	1 1/2	85
C-755-2C	1 1/8	2 3/32	2 3/32	1 1/2	82
C-755-3	1 1/4	3 3/8	2 5/8	2	114
C-755-3A	1 3/8	3 3/8	2 5/8	2	110
C-755-3B	1 1/2	3 3/8	2 5/8	2	105
C-755-3C	1 5/8	3 3/8	2 5/8	2	102
C-755-4	1 3/4	4 1/4	3 3/4	3	220
C-755-4A	1 7/8	4 1/4	3 3/4	3	214
C-755-4B	2	4 1/4	3 3/4	3	205
C-755-4C	2 1/8	4 1/4	3 3/4	3	200
C-755-5	2 1/4	4 3/4	4 1/4	3 1/2	260
C-755-5A	2 3/8	4 3/4	4 1/4	3 1/2	250
C-755-5B	2 1/2	4 3/4	4 1/4	3 1/2	243
C-755-5C	2 5/8	4 3/4	4 1/4	3 1/2	240
C-755-6	2 3/4	5 1/4	4 3/4	4	250
C-755-6A	2 7/8	5 1/4	4 3/4	4	240
C-755-6B	3	5 1/4	4 3/4	4	230
C-755-6C	3 1/8	5 1/4	4 3/4	4	220
C-755-7	3 1/4	6 1/16	5 1/16	5	340
C-755-7A	3 3/8	6 1/16	5 1/16	5	330
C-755-7B	3 1/2	6 1/16	5 1/16	5	318
C-755-7C	3 5/8	6 1/16	5 1/16	5	387
C-755-8	3 3/4	7 3/8	6 3/8	6	565
C-755-8A	3 7/8	7 3/8	6 3/8	6	550
C-755-8B	4	7 3/8	6 3/8	6	535
C-755-8C	4 1/8	7 3/8	6 3/8	6	520
C-755-8D	4 1/4	7 3/8	6 3/8	6	490
C-755-8E	4 3/8	7 3/8	6 3/8	6	475
C-755-8F	4 1/2	7 3/8	6 3/8	6	460

* Also available in thermoplastic, order as C775-TP.

C-756-1 Porcelain Saddle, C-756-2 Porcelain Saddle

- White-glaze dry-process porcelain cable rack insulator
- Fits all sizes of B-900 series channel including B-906

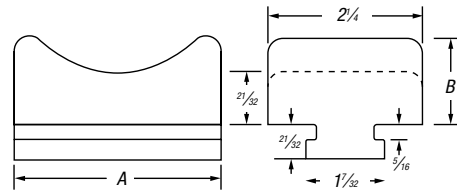
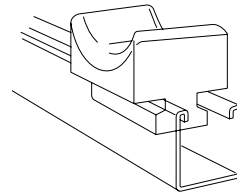

CAT. NO.	DIMENSIONS (IN.)	
	A	B
C-756-1	3	1 3/16
C-756-2	4	1 7/32

C-756-1 is for cables up to 3" O.D. Weight 72 lbs/C.
C-756-2 for cables up to 5" O.D. Weight 102 lbs/C.

Pipe Straps, Conduit Clamps and Hangers

C-755 — Porcelain Cable Clamps

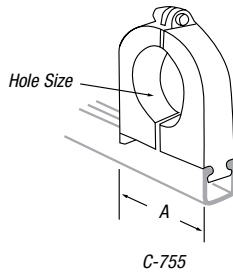

CAT. NO.	HOLE SIZE (IN.)	A (IN.)	STD. CTN.
C-755-1A	3/8	1 1/16	10
C-755-1B	1/2	1 1/16	10
C-755-1C	5/8	1 1/16	10
C-755-2	3/4	2 5/32	10
C-755-2A	7/8	2 5/32	10
C-755-2B	1	2 5/32	10
C-755-2C	1 1/8	2 5/32	10
C-755-3	1 1/4	2 5/8	10
C-755-3A	1 3/8	2 5/8	10
C-755-3B	1 1/2	2 5/8	10
C-755-3C	1 5/8	2 5/8	10
C-755-4	1 3/4	3 3/8	10
C-755-4A	1 7/8	3 3/8	10
C-755-4B	2	3 3/8	10
C-755-4C	2 1/8	3 3/8	10
C-755-5	2 1/4	4 1/4	10
C-755-5A	2 3/8	4 1/4	10
C-755-5B	2 1/2	4 1/4	10
C-755-5C	2 5/8	4 1/4	10
C-755-6	2 5/8	4 3/8	10
C-755-6A	2 7/8	4 3/8	10
C-755-6B	3	4 3/8	10
C-755-6C	3 1/8	4 3/8	10
C-755-7	3 1/4	5 1/16	10
C-755-7A	3 3/8	5 1/16	10
C-755-7B	3 1/2	5 1/16	10
C-755-7C	3 5/8	5 1/16	10
C-755-8	3 3/4	6 3/8	5
C-755-8A	3 7/8	6 3/8	5
C-755-8B	4	6 3/8	5
C-755-8C	4 1/8	6 3/8	5
C-755-8D	4 1/4	6 3/8	5
C-755-8E	4 3/8	6 3/8	5
C-755-8F	4 1/2	6 3/8	5

Finish – GoldGalv® brand with bronze hardware.

Also fits 1 1/2" wide channel.

C-755 — TPE Cable Clamps

An easy-to-use one-piece insulator made from Sarlink 4339D, a flame-retardant, high hardness grade TPE polymer that is UL Listed. The tapered flange of the insulator ensures complete isolation and protection of the cable. Options include a Stainless Steel Clamp and hardware or an Electro-Galvanized Clamp with Everdur nut and bolt.



- Non-breakable TPE material
- Exceptional chemical resistance
- Dielectric strength of 640 volts per mil
- Stainless Steel Clamps Type 304 or 316
- Electro-Galvanized Steel Clamps with Everdur Nut and Bolt
- Flame-retardant TPE insulator
- Excellent UV resistance

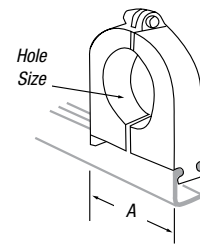

CAT. NO.	HOLE SIZE (IN.)	A (IN.)	CAT. NO.	HOLE SIZE (IN.)	A (IN.)
C755 1ATP	3/8	1.36	C-755-5B-TP	2 1/2	3.36
C-755-1B-TP	1/2	1.36	C-755-5C-TP	2 5/8	3.36
C-755-1C-TP	5/8	1.36	C-755-6-TP	2 3/4	3.86
C-755-2-TP	3/4	1.86	C-755-6A-TP	2 7/8	3.86
C-755-2A-TP	7/8	1.86	C-755-6B-TP	3	3.86
C-755-2B-TP	1	1.86	C-755-6C-TP	3 1/8	3.86
C-755-2C-TP	1 1/8	1.86	C-755-7-TP	3 1/4	4.36
C-755-3-TP	1 1/4	2.36	C-755-7A-TP	3 3/8	4.36
C-755-3A-TP	1 3/8	2.36	C-755-7B-TP	3 1/2	4.36
C-755-3B-TP	1 1/2	2.36	C-755-7C-TP	3 5/8	4.36
C-755-3C-TP	1 5/8	2.36	C-755-8-TP	3 3/4	4.86
C-755-4-TP	1 3/4	2.86	C-755-8A-TP	3 7/8	4.86
C-755-4A-TP	1 7/8	2.86	C-755-8B-TP	4	4.86
C-755-4B-TP	2	2.86	C-755-8C-TP	4 1/8	4.86
C-755-4C-TP	2 1/8	2.86	C-755-8D-TP	4 1/4	5.24
C-755-5-TP	2 1/4	3.36	C-755-8E-TP	4 3/8	5.24
C-755-5A-TP	2 3/8	3.36	C-755-8F-TP	4 1/2	5.24

Pipe Straps, Conduit Clamps and Hangers

C-755 — Beam Clamp

Designed to attach to the bottom of flanged beams. Normally used with the E-157 Eye Rod or E-120-A Eye Nut.

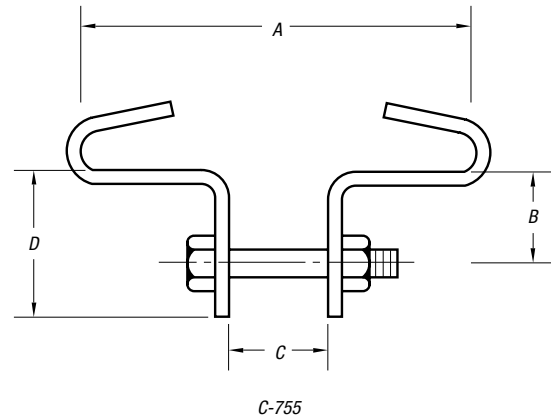

Specifications

- Material: Carbon Steel
- Compliance: Federal Specification A-A-1192A Type 21, MSS-SP-69 Type 21
- Finish: Standard Finish – GoldGalv®, Black (add suffix “-B”), Electro-Galvanized (add suffix “-EG”), Thermoplastic (add suffix “-TP”)
- Ordering: Specify clamp size, flange width, flange thickness, catalog number and finish.

CAT. NO.	CLAMP SIZE	MAX. LOAD (LBS.)	DIMENSIONS (IN.)			BOLT SIZE (IN.)
			B	C	D	
C-755-1	1	500	7/8	1/2	1 1/2	3/8
C-755-2	2	700	1 1/8	5/8	1 3/4	1/2
C-755-3	3	800	1 1/4	5/8	2	1/2
C-755-4	4	1,000	1 3/8	3/4	2 3/8	5/8
C-755-5	5	3,000	1 7/8	7/8	2 7/8	3/4
C-755-6	6	3,000	2	1	3	7/8
C-755-7	7	5,000	2 1/8	1 1/8	4 1/8	1

CAT. NO.	CLAMP SIZE	WEIGHT EACH (LBS.) BEAM WIDTH — DIMENSION “A”							
		2	3	4	5	6	7	8	10
C-755-1	1	.52	.62	.78	.88	.95	—	—	—
C-755-2	2	.74	.82	1.09	1.21	1.31	1.39	—	—
C-755-3	3	1.26	1.49	1.89	2.12	2.29	2.45	2.69	—
C-755-4	4	—	2.32	2.85	3.18	3.39	3.60	3.92	—
C-755-5	5	—	3.40	4.08	4.52	4.80	5.10	5.51	6.23
C-755-6	6	—	—	6.00	6.45	7.00	7.40	7.90	8.80
C-755-7	7	—	—	—	11.95	12.75	13.55	14.35	15.95

Technical Information

Federal Specifications (WW-H-171)/ Manufacturers Society Specifications (MSS SP69)



C-710
Adj. Steel Clevis
Sizes 3/4" through 20" IPS
Federal Type 1
SP69 Type 1



C-726
Steel Double Bolt Pipe Clamp
Sizes 1 1/2" through 24" IPS
Federal Type 3
SP69 Type 3

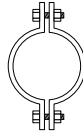

C-725
Steel Pipe Clamp
Sizes 1 1/2" through 24" IPS
Federal Type 4
SP69 Type 4



CF-710
Adj. Steel Band Hanger
Sizes 1/2" through 8"
IPS 3/4" through 4" tube
Federal Type 7

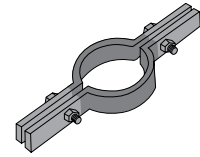

C-720/CT-720
Extension Pipe or Riser Clamp
Sizes 3/4" through 20"
IPS 1/2" through 6" tube
Federal Type 8
SP69 Type 8



C-727/CT-727
Adj. Swivel Ring Hanger
Sizes 1/2" through 8" IPS
1/2" through 4" tube
Federal Type 10
SP69 Type 10

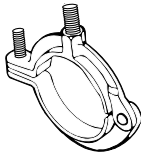

M-718/MT-718
MI Split Pipe Ring
w/wo turnbuckle adj.
Sizes 1/2" through 8" IPS
1/2" through 4" tube
Federal Type 11
SP69 Type 12



CL-710
Light-Duty Clevis Hanger
Sizes 1/2" through 4"
Federal Type 12



F-112
Forged Steel Turnbuckle
Sizes 3/8" through 1 1/2" rod
Federal Type 13
SP69 Type 13



F-111
Forged Steel Clevis
Sizes 3/8" through 1 1/2" rod
Federal Type 14
SP69 Type 13

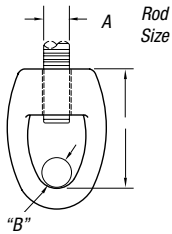

M-117
MI Socket only for
S Split Ring Hanger
Sizes 3/8" through 1 1/2" Rod
Federal Type 16
SP69 Type 16



E-120-A
Forged Steel Weldless Eye Nut
Sizes 3/8" through 1 1/2" rod
Federal Type 17
SP69 Type 17

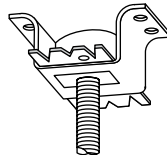

452
Steel Concrete Insert
Federal Type 19
SP69 Type 18

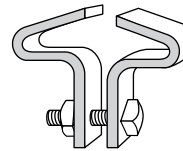

C-755 T/C-757 T
Center I-Beam Clamp
Federal Type 21
SP69 Type 21

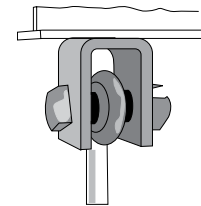

C-780
Welded attachment as
shown or inverted less bolt
Federal Type 22
SP69 Type 22



M-775-L/C-775-L
MI or Steel C-Clamp
Sizes 3/8" through 1 1/2"
Federal Type 23
SP69 Type 23



H-115
U-Bolt
Sizes 1/2" through 24" IPS
Federal Type 24
SP69 Type 24

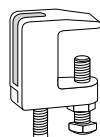

M-778
Top Beam C-Clamp
Sizes 3/8" through 3/4" rod
SP69 Type 19

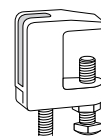

M-777
Junior Top Beam C-Clamp
Sizes 3/8" through 1/2" rod
SP69 Type 18

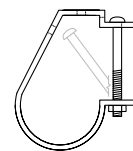

C-711
"J" Pipe Hanger
Sizes 1/2" through 8" pipe
SP69 Type 5