

Flush Service Floor Boxes

Floor Boxes for Single Short-Strap Receptacles or Communications

Service Fitting Application

78 and 88 Series Floor Boxes provide flush service for power or communications and data. They can be used for either carpet or tile applications.

78 Series



78SC

- **Cast iron**, watertight body, semi-adjustable
- Painted silver enamel inside and out for additional corrosion resistance
- Exterior leveling screws and threaded vertical adjusting ring permit adjustment to meet finish floor
- Shipped complete with expandable cap to prevent ingress of concrete during pour
- 3/4" threaded conduit openings
- Uses P90 Series MopTite® covers

88 Series



88-D

- **Stamped steel**, concrete-tight, semi-adjustable
- Electro-galvanized body and hardware
- Exterior leveling screws and threaded vertical adjusting ring permit adjustment to meet finish floor
- Shipped complete with expandable cap to prevent ingress of concrete during pour
- 1/2" and 3/4" knockouts — all bottom knockouts accessible
- Uses P90 Series MopTite® covers



CAT. NO.	DESCRIPTION	STD. CTN.
78SC	Cast-Iron Single-Gang Floor Box with 3/4" Conduit Tapping	4
78-S	Cast-Iron Single-Gang Floor Box (shallow)	4
88-D	Stamped-Steel Single-Gang Floor Box with 1/2" and 3/4" Conduit Tapping	4
88-S	Shallow Version Stamped Steel	4

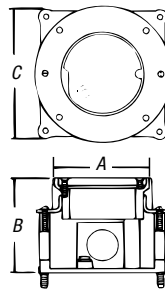
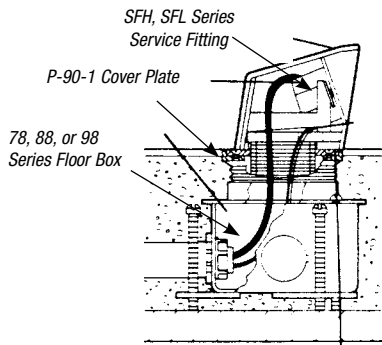

Engineering Data



CAT. NO.	DIMENSIONS (IN.)			BEFORE POUR ADJ. (IN.)	AFTER POUR ADJ. (IN.)	MAXIMUM CAPACITY CU. IN.	STANDARD CONDUIT TAPPING (IN.)
	A	B	C				
78SC	3	2 3/16	3 3/8	2 1/2	3/4	24	3/4
78-S	3	2 3/8	3 3/8	1 1/2	3/4	20	3/4
88-D	3	3 1/4	5 3/4	2 1/2	3/4	29	—
88-S	3	2 3/4	5 3/4	1 1/2	3/4	23	—

Flush Service Floor Boxes



Engineering Data (continued)

CAT. NO.	MAXIMUM CONDUIT TAPPING (IN.)		CONDUIT KOS (IN.)		COVERS AND CARPET PLATES	WIRING DEVICE
	W/BUSHING	W/O BUSHING	SIDES	BOTTOM		
78SC	3/4	1	—	—	P90 series	Sing. short, Strap rec.
78-S	3/4	1	—	—	P90 series	Sing. short, Strap rec.
88-D	—	—	(2) 1/2 (2) 3/4	(3) 1/2 (2) 3/4	P90 series	Sing. short Strap rec.
88-S	—	—	(2) 1/2 (2) 3/4	(3) 1/2 (2) 3/4	P90 series	Sing. short Strap rec.

MopTite® Cover Plates for 78 and 88 Series

- Polished-brass finish
- Furnished complete with sealing gasket and 6-32 x 1/2" brass screws
- 2 13/16" outside diameter
- For brushed aluminum, add AL after catalog number



P-90-1/2
1/2" N.P.S. plug



P-90-3/4
3/4" N.P.S. plug



P-90-1
1" N.P.S. plug

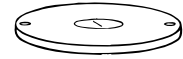

P-90-1-1/4
1 1/4" N.P.S. plug

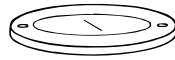

P-90-2*
2" dia. plug

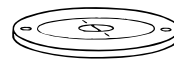

P-90-1/2-2*
1/2" & 2" dia. plugs

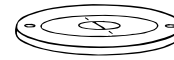

P-90-3/4-2*
3/4" & 2" dia. plugs



CAT. NO.	DESCRIPTION	FINISH	STD. CTN.
P-90-1/2	Cover Plate 1/2" NPS Plug	Brass	4
P-90-3/4	Cover Plate 3/4" NPS Plug	Brass	4
P-90-3/4-AL	Cover Plate 3/4" NPS Plug	Aluminum	4
P-90-1	Cover Plate 1" NPS Plug	Brass	4
P-90-1-AL	Cover Plate 1" NPS Plug	Aluminum	4
P-90-1-1/4	Cover Plate 1 1/4" NPS Plug	Brass	4

CAT. NO.	DESCRIPTION	FINISH	STD. CTN.
P-90-1-1/4-AL	Cover Plate 1 1/4" NPS Plug	Aluminum	4
P-90-2	Cover Plate 2" UN Plug	Brass	4
P-90-2-AL	Cover Plate 2" UN Plug	Aluminum	4
P-90-1/2-2	Cover Plate 1/2" & 2" Plug	Brass	4
P-90-3/4-2	Cover Plate 3/4" & 2" Plug	Brass	4
P-90-3/4-2-AL	Cover Plate 3/4" & 2" Plug	Aluminum	4

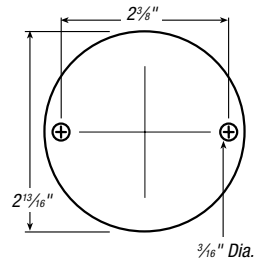

New MopTite® Covers exceed UL watertight requirements for 514A, 514C.

*Also includes steel seating plates for receptacles.

For above-floor service fittings for 78, 88 and 98 series floor boxes, see page A-170

Accessories for 78 and 88 Series Floor Boxes

- Extends vertical adjusting ring 1 1/8"
- Seven cubic inch capacity
- 15-Amp, 125-Volt, NEMA grounding type
- Mounted on steel seating plate
- For use with 2" diameter-opening floor plate



478-G-12



8805-E



CAT. NO.	DESCRIPTION	STD. CTN.
8805-E	Extension Adjusting Ring	4
478-G-12	15-Amp 125-Volt NEMA Grounding Receptacle	4

Carpet Plate for 78 and 88 Series Floor Boxes

- Polished-brass finish
- 3/8" O.D. with 5/8" flange
- Furnished complete with 6-32 x 1" brass flathead screws and gasket
- Threaded 2-20UN-2B to accept 694 plug
- For brushed aluminum, add AL after catalog number

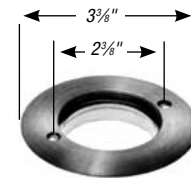

P-90-CP



CAT. NO.	DESCRIPTION	FINISH	STD. CTN.
P-90-CP	Carpet Plate	Brass	4
P-90-CP-AL	Carpet Plate	Aluminum	4

Will not accept P90 covers. Will accept 694 threaded plug.