

Nylon or Vinyl Insulated

*Most standard bulk catalogue numbers can be put on Mylar Tape for reel fed applications (i.e. 12050 tool and application dies). See pages 196-197. Please put the suffix M for Mylar Tape RA2573M. (Bulk number 1000 and 500 packages.)*

Material: copper .050 thk.  
Finish: electro tin-plate  
Wire Range: #16-14  
Colour Code: green vinyl or nylon insulator

## Nylon #16-14 AWG – Heavy Duty

| Cat. No.  | Pkg. Qty. | Wire Range       | Max. Ins. | Bolt Hole | Wt./lb. Per 1000 | Dimensions |     |     |      |
|-----------|-----------|------------------|-----------|-----------|------------------|------------|-----|-----|------|
|           |           |                  |           |           |                  | A          | B   | C   | M    |
| RBC14-6   | 50        | 16-14 heavy duty | .210      | #6        | —                | .98        | .25 | .29 | .85  |
| RBC853    | 500       | use RC tooling   | .210      | #6        | —                | .98        | .25 | .29 | .85  |
| RBC14-8   | 50        | 16-14 heavy duty | .210      | #8        | —                | 1.04       | .39 | .29 | .85  |
| RBC863    | 500       | use RC tooling   | .210      | #8        | —                | 1.04       | .39 | .29 | .85  |
| RBC14-10  | 50        | 16-14 heavy duty | .210      | #10       | —                | 1.04       | .39 | .29 | .85  |
| RBC873    | 500       | use RC tooling   | .210      | #10       | —                | 1.04       | .39 | .29 | .85  |
| RBC14-14  | 50        | 16-14 heavy duty | .210      | 1/4       | —                | 1.10       | .51 | .29 | .85  |
| RBC713    | 500       | use RC tooling   | .210      | 1/4       | —                | 1.10       | .51 | .29 | .85  |
| RBC14-516 | 50        | 16-14 heavy duty | .210      | 5/16      | —                | 1.21       | .54 | .38 | .94  |
| RBC723    | 500       | use RC tooling   | .210      | 5/16      | —                | 1.21       | .54 | .38 | .94  |
| RBC14-38  | 50        | 16-14 heavy duty | .210      | 3/8       | —                | 1.26       | .63 | .38 | .94  |
| RBC793    | 500       | use RC tooling   | .210      | 3/8       | —                | 1.26       | .63 | .38 | .94  |
| RBC14-12  | 50        | 16-14 heavy duty | .210      | 1/2       | —                | 1.49       | .76 | .54 | 1.11 |
| RBC753    | 500       | use RC tooling   | .210      | 1/2       | —                | 1.49       | .76 | .54 | 1.11 |

ERG4001, WT2000, WT145C, and power tools as recommended crimp in the 12-10 nest (yellow)

## Vinyl #16-14 AWG – Heavy Duty

| Cat. No.  | Pkg. Qty. | Wire Range       | Max. Ins. | Bolt Hole | Wt./lb. Per 1000 | Dimensions |     |     |      |
|-----------|-----------|------------------|-----------|-----------|------------------|------------|-----|-----|------|
|           |           |                  |           |           |                  | A          | B   | C   | M    |
| 14RBC-6   | 50        | 16-14 heavy duty | .210      | #6        | 5                | 1.06       | .25 | .29 | .93  |
| RBC857    | 500       | use RC tooling   | .210      | #6        | 5                | 1.06       | .25 | .29 | .93  |
| 14RBC-8   | 50        | 16-14 heavy duty | .210      | #8        | 5                | 1.13       | .39 | .29 | .93  |
| RBC867    | 500       | use RC tooling   | .210      | #8        | 5                | 1.13       | .39 | .29 | .93  |
| 14RBC-10  | 50        | 16-14 heavy duty | .210      | #10       | 5                | 1.13       | .39 | .29 | .93  |
| RBC877    | 500       | use RC tooling   | .210      | #10       | 5                | 1.13       | .39 | .29 | .93  |
| 14RBC-14  | 50        | 16-14 heavy duty | .210      | 1/4"      | 6                | 1.19       | .51 | .29 | .93  |
| RBC717    | 500       | use RC tooling   | .210      | 1/4"      | 6                | 1.19       | .51 | .29 | .93  |
| 14RBC-516 | 50        | 16-14 heavy duty | .210      | 5/16"     | 6                | 1.29       | .54 | .38 | 1.03 |
| RBC727    | 500       | use RC tooling   | .210      | 5/16"     | 6                | 1.29       | .54 | .38 | 1.03 |
| 14RBC-38  | 50        | 16-14 heavy duty | .210      | 3/8"      | 6                | 1.34       | .63 | .38 | 1.03 |
| RBC797    | 500       | use RC tooling   | .210      | 3/8"      | 6                | 1.34       | .63 | .38 | 1.03 |
| 14RBC-12  | 50        | 16-14 heavy duty | .210      | 1/2"      | 6                | 1.57       | .76 | .54 | 1.19 |
| RBC757    | 500       | use RC tooling   | .210      | 1/2"      | 6                | 1.57       | .76 | .54 | 1.19 |

## Non-Insulated #16-14 AWG – Heavy Duty

| Cat. No. | Pkg. Qty. | Wire Range       | Max. Ins. | Bolt Hole | Wt./lb. Per 1000 | Dimensions |     |     |     |
|----------|-----------|------------------|-----------|-----------|------------------|------------|-----|-----|-----|
|          |           |                  |           |           |                  | A          | B   | C   | M   |
| BC14-6   | 100       | 16-14 heavy duty | —         | #6        | —                | .81        | .25 | .29 | .68 |
| BC85     | 500       | use RC tooling   | —         | #6        | —                | .81        | .25 | .29 | .68 |
| BC14-8   | 100       | 16-14 heavy duty | —         | #8        | —                | .87        | .39 | .29 | .68 |
| BC86     | 500       | use RC tooling   | —         | #8        | —                | .87        | .39 | .29 | .68 |
| BC14-10  | 100       | 16-14 heavy duty | —         | #10       | —                | .87        | .39 | .29 | .68 |
| BC87     | 500       | use RC tooling   | —         | #10       | —                | .87        | .39 | .29 | .68 |
| BC14-14  | 100       | 16-14 heavy duty | —         | 1/4       | —                | .93        | .51 | .29 | .68 |
| BC71     | 500       | use RC tooling   | —         | 1/4"      | —                | .93        | .51 | .29 | .68 |
| BC14-516 | 100       | 16-14 heavy duty | —         | 5/16      | —                | 1.04       | .54 | .38 | .77 |
| BC72     | 500       | use RC tooling   | —         | 5/16"     | —                | 1.04       | .54 | .38 | .77 |
| BC14-38  | 100       | 16-14 heavy duty | —         | 3/8       | —                | 1.09       | .63 | .38 | .77 |
| BC79     | 500       | use RC tooling   | —         | 3/8"      | —                | 1.09       | .63 | .38 | .77 |
| BC14-12  | 100       | 16-14 heavy duty | —         | 1/2       | —                | 1.32       | .76 | .54 | .94 |
| BC75     | 500       | use RC tooling   | —         | 1/2"      | —                | 1.32       | .76 | .54 | .94 |

ERG4002, WT111M, WT2000, and power tools as recommended, crimp in the 12-10 nest

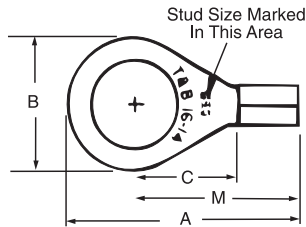

Non-Insulated