

BLUE BRUTE FITTINGS

Blue Brute Fittings 4" - 12" (100mm - 300mm)
IPEX Centurion Fittings 14" - 24" (350mm - 600mm)

BLUE BRUTE

Blue Brute fittings are injection molded and are even tougher than the pipe. Blue Brute fittings have a wall thickness 25% greater than DR18 pipe, and some custom-made fabricated fittings are wrapped with a tough layer of fiberglass for extra protection.

APPLICATIONS

- Municipal Water Systems
- Fire Lines
- Industrial Lines
- Forcemains
- Irrigation Lines

STANDARDS



ADVANTAGES

- 1 Corrosion-Proof Performance**
Blue Brute systems are immune to corrosion from aggressive soils and galvanic action.
- 2 Superior Hydraulics**
The glass-like finish of PVC reduces friction losses and eliminates the tuberculation common in iron pipes. As a result, pumping costs are reduced and water quality is maintained.
- 3 Strength**
A thicker bell results in a more robust fitting.
- 4 Gasket Options**
All Blue Brute fittings are shipped with standard gaskets that accept cast-iron-sized PVC pipe. Transition gaskets for IPS-sized pipe are an option for all sizes. For applications where fittings must be buried in soil with hydrocarbon contamination, Nitrile gaskets are available.
- 5 Saves Time & Money**
A consistent O.D. for each size simplifies the restraint selection. Each fitting is labeled with the O.D. information for easy identification and restraint selection.

PRODUCT SELECTION CHART - PC/PR 235 PSI (1620 KPA)

	Dimension		Product Code
	inches	mm	

High Deflection Couplings

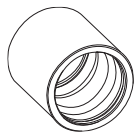

10	250	273526
12	300	273527

Reducer Coupling B x B

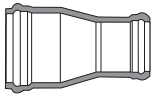

* 6 x 4	150 x 100	273226
* 8 x 6	200 x 150	273227
* 10 x 6	250 x 150	273228
* 10 x 8	250 x 200	273229
* 12 x 8	300 x 200	273231
* 12 x 10	300 x 250	273232

Plug Plain End



4	100	073180
6	150	073181
8	200	073182
10	250	073183
12	300	073184

Tapped Plug (I.P.S. Threads)



4 x 3/4	100 x 20	273192
4 x 1	100 x 25	073193
4 x 1-1/2	100 x 40	073194
4 x 2	100 x 50	273195
6 x 3/4	150 x 20	273199
6 x 1	150 x 25	273200
6 x 1-1/2	150 x 40	273201
6 x 2	150 x 50	273196
8 x 3/4	200 x 20	073203
8 x 1	200 x 25	073204
8 x 1-1/2	200 x 40	073197
8 x 2	200 x 50	273198

Cast Iron Size x I.P.S. Transition Gasket

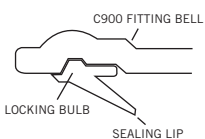

4	100	073655
6	150	073611
8	200	073656

Gasket drawing is for information only. Actual gasket may be different.

	Dimension		Product Code
	inches	mm	

C900 Bell x Flange Adapter

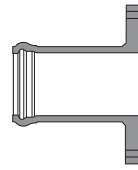

* 4	100	273015
* 6	150	273016
* 8	200	273017
* 10	250	273018
* 12	300	273019

* Fabricated fitting – Fibreglass reinforced

C900 (Spigot) x I.P.S. (Bell) Adapter

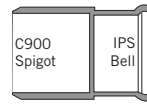

* 4	100	273346
* 6	150	273347

SBR Gasket

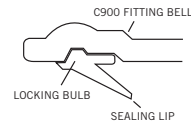

4	100	072344
6	150	072346
8	200	273348
10	250	072350
12	300	072352

Gasket drawing is for information only. Actual gasket may be different.

Nitrile Gasket (Oil Resistant)

4	100	072924
6	150	072926
8	200	072928
10	250	072930
12	300	072932

EPDM Gasket

4	100	272048
6	150	272011
8	200	272039
10	250	272040
12	300	272012