

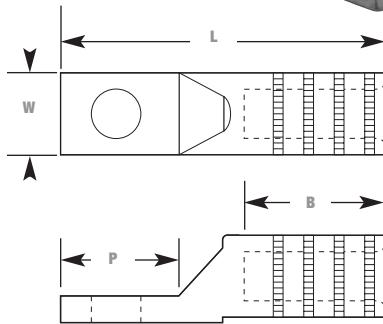

MSL 350



Aluminum Lugs

Tin-Plated Meter Socket Lugs — Star Hole

Dual-rated, corrosion-resistant lugs available with star holes

- Provides high strength and high-conductivity
- Use with aluminum and copper conductors
- Resistant to corrosion
- Prevents oxidation and keeps out moisture

Cat. No.	Conductor Size	Installing Dies	Dimensions			
			W	L	P	B
MSL 4	#4 str. cpt.	840, 845, TX, 76, 249, 11A	15/16	3-1/4	1-5/16	1-3/8
MSL 2	#2 str. cpt. sol.					
MSL 1/0	1/0 str. cpt.					
MSL 2/0	2/0 str. cpt.					
MSL 3/0	3/0 str. cpt.					
MSL 4/0	4/0 str. cpt.					
MSL 250	250 str. cpt.					
MSL 300	300 str. cpt.					
MSL 350	350 str. cpt.					
MSL 500	500 str.	106A, 300, 317, 1-5/16, 15A	1-3/4	4-7/8	1-3/4	3-3/16