

Semiconductor Fuses

Large rectifier PSC fuse selection



25 URD 123 TTF 630



4 URD TDF 1000



9,5 URD 94 PPASF 3800
+ MC3E 1-5N

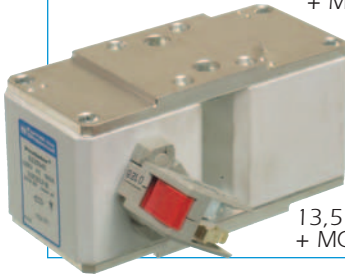

13,5 URD 283 PLAF 1600
+ MCR3E 1-5NBS

Ferraz Shawmut PSC-LR fuse-links provide maximum flexibility in equipment design and ultimate protection for today's power conversion equipment. These square body fuse-links are available in various body sizes with a broad range of ampere ratings allowing the greatest flexibility in equipment design.

The Ferraz Shawmut PSC-LR fuse range has been engineered to provide state of the art protection for high power semiconductors such as diodes, thyristors, GTO's, IGCT's and IGBT's.

They have pure silver fuse elements embedded in solidified sand which provides optimized I²t and high interrupting rating. All contact surfaces are plated and all hardware non-magnetic.

All fuses are standard with a low voltage blown fuse indicator. This indicator can operate a microswitch which is easily mounted directly onto the fuse in service.



13,5 URD 294 TDSFF 3400
+ MCR3E 1-5NBS



13 URD 84 TQFPLA 0900

HIGHLIGHTS

- Highly current limiting.
- Isolating fuse
- High breaking capacities
- High capability of selection in case of external fault
- Worldwide acceptance.
- Superior cycling ability.
- High withstanding in rush current and overloads
- Optimized coordination ratio

APPLICATIONS

Protection of large rectifiers, inverters, static transfer switch, AC & DC drives and UPS systems.

Ratings

AC: up to 10 000A
130 V - 3 800V
100 - 240 kA IR
DC: Consult Factory

Approvals

AC: Tested to IEC 60269-4

Features/Benefits

Customized terminals available under request

Wide range of mounting styles

Broad range of ampere ratings in each body size for design flexibility

IEC 269-4 compliance for fuses for worldwide semiconductor applications



Semiconductor Fuses

PSC - LR range - Size 33

130 - 550 V
630 - 7500 A

PSC - LR range

Size	Ratings (A) In	Voltage (V) Un	Pre-Arcing I ² t @ 1ms I ² tp (kA ² s)	Total I ² t @ Un (kA ² s)	I @ 10ms (A)	Power losses (W)		Breaking capacities (kA) @ U _N
						0.8In	In	
	630	400	22,5	200	2 550	55	90	100
	700	400	27,5	250	2 850	60	100	100
	800	400	33,5	300	3 300	70	115	100
	900	400	47	430	3 700	80	130	100
	1 000	400	52	480	4 100	85	140	100
	1 100	400	63	580	4 550	100	160	100
33	1 250	400	88	800	5 400	110	180	100
Press Pack	1 400	380	133	1 050	6 600	130	210	100
	1 600	300	208	1 300	8 200	140	230	230
	1 750	300	252	1 570	9 000	150	250	230
	1 800	300	252	1 570	10 000	160	260	230
	2 000	300	468	2 900	12 500	170	280	230
	2 800	300	1600	8 100	24 000	208	270	200
	3 200	300	1900	9 400	26 000	231	300	200
	3 750	150	1870	9 100	25 000	294	350	200
	630	400	22,5	200	2 550	55	90	100
	700	400	27,5	250	2 850	60	100	100
	800	400	33,5	300	3 300	70	115	100
	900	400	47	430	3 700	80	130	100
	1 000	400	52	480	4 100	85	140	100
	1 100	400	63	580	4 550	100	160	100
	1 250	400	88	800	5 400	110	180	100
33	1 400	380	133	1 050	6 600	130	210	100
End contacts	1 600	300	208	1 300	8 200	140	230	230
	1 750	300	252	1 570	9 000	150	250	230
	1 800	300	252	1 570	10 000	160	260	230
	2 000	300	468	2 900	12 500	170	280	230
	2 500	150	1200	5 750	17 000	140	275	230
	3 000	150	1735	8 360	20 000	175	348	230
	3 500	150	2370	11 400	24 000	195	335	230
	4 000	150	3100	14 800	27 000	215	422	230
	4 500	150	3900	18 700	31 000	237	465	230
	4 700	150	4750	22 500	33 500	240	470	230
	3 000	550	1900	9000	25000	245	445	150
	3 200	550	2200	10800	27000	239	435	150
	3 600	500	2900	12400	31000	256	465	130
	4 000	500	3800	16200	36000	283	515	130
	4 500	450	5000	18600	41000	308	560	130
	5 000	400	7500	23100	50000	319	580	200
	2 000	350	440	2790	10400	135	255	200
	2 500	350	800	5220	16400	155	295	200
	3 200	300	1600	8700	24000	195	370	200
2x33	3 600	300	1880	9750	26000	210	390	200
Double body	4 000	260	3040	13250	32000	240	455	200
End contact	4 400	260	3200	14300	34000	260	485	200
	5 000	260	5200	23000	44000	270	505	200
	6 400	260	7600	32700	50000	340	640	200
	3 200	180	960	5440	17600	195	390	200
	3 600	180	1160	6460	20000	205	410	200
	4 000	180	1560	8840	24000	235	465	200
	4 400	180	1880	10540	26000	245	485	200
	5 000	130	3040	12920	32000	255	505	200
	5 600	130	3800	15980	34000	290	580	200
	6 400	130	5000	20740	42000	315	630	200
	7 200	130	6500	27200	46000	350	695	200
	7 500	130	7500	30940	50000	370	735	200

For other ratings consult us

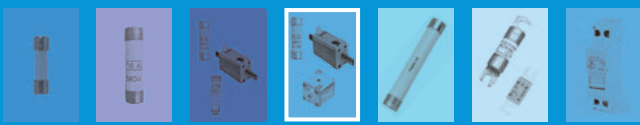

Semiconductor Fuses

PSC - LR range - Size 33

Size	Catalog Number	Weight (g)	Packaging
	1,5 URC 33 PPAF 3750		
	3 URC 33 PPAF 3200		
	3 URC 33 PPAF 2800		
	3 URC 33 PPAF 1600		
	3 URC 33 PPAF 1750		
	3 URC 33 PPAF 1800		
33	3 URC 33 PPAF 2000		
Press Pack	3,8 URC 33 PPAF 1400	900	3
	4 URC 33 PPAF 0630		
	4 URC 33 PPAF 0700		
	4 URC 33 PPAF 0800		
	4 URC 33 PPAF 0900		
	4 URC 33 PPAF 1000		
	4 URC 33 PPAF 1100		
	4 URC 33 PPAF 1250		
	1,5 URCG 33 TDF 2500		
	1,5 URCG 33 TDF 3000		
	1,5 URCG 33 TDF 3500		
	1,5 URCG 33 TDF 4000		
	1,5 URCG 33 TDF 4500		
	1,5 URCG 33 TDF 4700		
	3 URC 33 TDF 1600		
	3 URC 33 TDF 1750		
33	3 URC 33 TDF 1800		
End contacts	3 URC 33 TTF 2000	1250	3
	3,8 URC 33 TTF 1400		
	4 URC 33 TTF 0630		
	4 URC 33 TTF 0700		
	4 URC 33 TTF 0800		
	4 URC 33 TTF 0900		
	4 URC 33 TTF 1000		
	4 URC 33 TTF 1100		
	4 URC 33 TTF 1250		

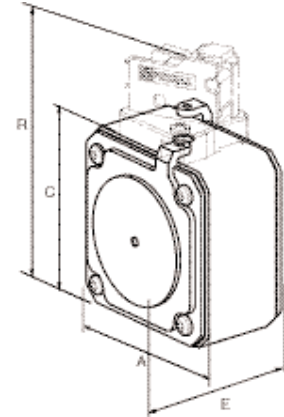

PPAF
Press Pack

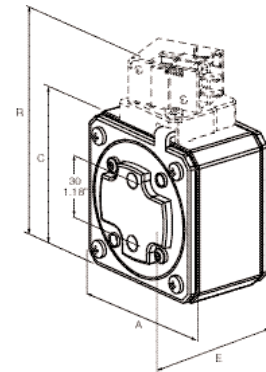

TDF
End contacts

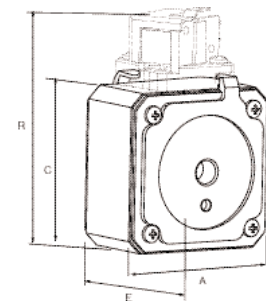

TTF
End contacts