

Surge-Trap[®] Pluggable SPD

DIN-rail Style SPD

Surge-Trap[®] Pluggable Surge Protective Device (SPD) is a no-fuse, fail-safe surge suppressor featuring Mersen's patented T_{PMOV}[®] technology inside. The pluggable SPD is UL 1449 Third Edition approved. It is DIN-rail mountable featuring a fail-safe self-protected design, visual indicator and a small footprint. A remote indicator option provides status to critical control circuits. The Surge-Trap Pluggable SPD has a high short circuit rating and a thermally protected MOV, which eliminates the need for additional overcurrent protection devices.

Features/Benefits:

- Easy installation or retrofit
- DIN-rail mountable
- Fail-safe, self-protected design
- Remote indicator
- Visual indicator
- IP20 finger-safe design
- Small footprint
- No additional overcurrent protection devices required
- Easy to replace modules
- Two-year warranty

Applications:

- AC/DC distribution
- Power supplies
- Industrial automation
- Telecommunications
- Motor controls and starter systems
- Programmable logic controller (PLC)
- Power transfer equipment
- Photovoltaic systems
- HVAC applications
- AC drives
- UPS systems
- Security systems
- IT/Data centers
- Medical equipment

Dimensions

Poles	in	A mm
1 Pole	0.71	18.03
2 Pole	1.42	36.06
3 Pole	2.13	54.10
4 Pole	2.84	72.13

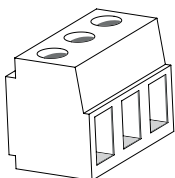
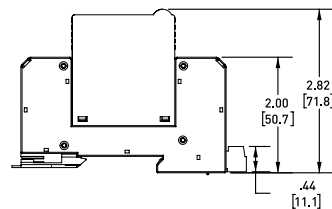
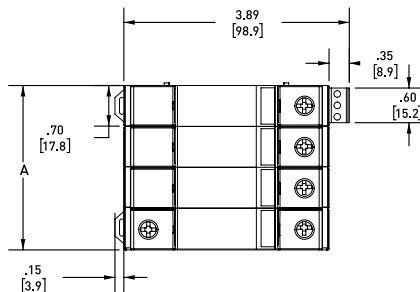
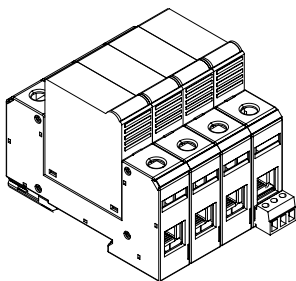

Signal Wire Range: #16 to #30 AWG

- Terminal Torque 2.2 lb-in
- Cont. between Comm + NO = Product Offline, Not Protected
- Cont. between Comm + NC = Product Online, Protected

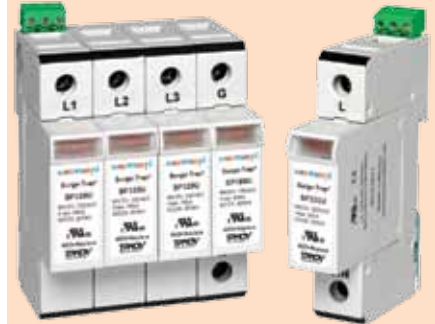

Ratings

Max Discharge Current

: 50kA (most models)

Volts

: 120V to 600V AC
: 600V to 1000V DC (PV only)

SCCR : 200kA

Operating & storage temp

: -40°C to +85°C

Wiring range:

: #6 to #14AWG

Nominal discharge current

: 20kA (most models)

Approvals:

- UL 1449 Third Edition Approved, File E210793
- Type 4 UL Recognized Component (Tested to UL Type 2 SPD)
- IEC 61643-11
- RoHS Compliant
- ANSI/IEEE C62.41
- CE



Surge-Trap® Pluggable SPD

Product Type	Voltage	System Type	Mode	Auxiliary Microswitch
STP - Pluggable	480 120 120/208 120/240 240 277 347 480 240/480 277/480 347/600 600 1000 1200	3PY 1P - Single Phase SP - Split Phase 3PD - 3 Phase Delta 3PH - 3 Phase Highleg 3PY - 3 Phase Wye PV - Photovoltaic	G Blank - Includes N-G Mode G - Does Not Provide N-G Mode	M M - Microswitch Included

Indicates PV only

Catalog Numbers

Catalog No.	Nominal Voltage (VAC)	MCOV L-G	No. of Poles	System Type	Nominal Discharge Current (I_n , kA)	Max. Discharge Current (I_{max} 8/20 μ s, kA)	SCCR (kA)	Freq (Hz)	Replacement Plug Part No	Voltage Protection Rating (VPR)				No. of Wires	Circuit Connection Wiring Diagrams
										L-N	L-G	N-G	L-L		
STP1201PGM	120	180	1	1P	20	50	200	50/60	SP180U	600				2	A
STP2083PYM	120/208	360	4	3PY	20	50	200	50/60	SP180U	600	1200	600	1200	5	D
STP2083PYGM	120/208	180	3	3PY	20	50	200	50/60	SP180U	600			1200	4	C
STP2301PGM	230	275	1	1P	20	50	200	50/60	SP275U	900				2	A
STP2403PDGM	240D	275	3	3PD	20	50	200	50/60	SP275U		900		1800	4	C
STP2403PHM	120/240	*	4	3PH	20	50	200	50/60	SP180U, SP275U	600	1200	600	1200	5	E
STP240SPGM	120/240	180	2	SP	20	50	200	50/60	SP180U	600			1200	3	B
STP2771PGM	277	320	1	1P	20	50	200	50/60	SP320U	1000				2	A
STP3471PGM	347	420	1	1P	20	50	200	50/60	SP420U	1500				2	A
STP4803PDGM	480D	550	3	3PD	20	50	200	50/60	SP550U		1800		3000	4	C
STP4803PHM	240/480	*	4	3PH	10	50	200	50/60	SP275U, SP550U, SP180U	900	1500	600	1800	5	E
STP4803PYM	277/480	500	4	3PY	20	50	200	50/60	SP320U, SP180U	1000	1500	600	1800	5	D
STP4803PYGM	277/480	320	3	3PY	20	50	200	50/60	SP320U	1000			1800	4	C
STP480SPGM	240/480	275	2	SP	20	50	200	50/60	SP275U	900			1800	3	B
STP6003PYM	347/600	695	4	3PY	20	50	200	50/60	SP420U, SP275U	1500	2000	900	2500	5	D
STP6003PYGM	347/600	420	3	3PY	20	50	200	50/60	SP420U	1500			2500	4	C

Catalog No. PV	Nominal Operating DC Voltage (V)	U_{cpv} *	Nominal Discharge Current (I_n 8/20, kA)	I_{max} Discharge Current (I_{max} 8/20 μ s, kA)	Voltage Protection Level (U_p @ I_n , kV)	I_{scpv}^{**} (kA)	L/R	Replacement Plug Part No	No. of Poles	Wiring Diagrams
STP600PVM	600	750	20	40	<2.0	10	<= 1mS	SP745PV	2	F
STP600YPVM	600	750	20	40	<3.0	10	<= 1mS	SP420PV	3	G
STP1000YPVM	1000	1250	20	40	<4.0	10	<= 1mS	SP670PV	3	G

* U_{cpv} : Maximum continuous operating DC voltage between L-G and L-L. **Short Circuit Current Rating values based upon SPD type 2 testing.

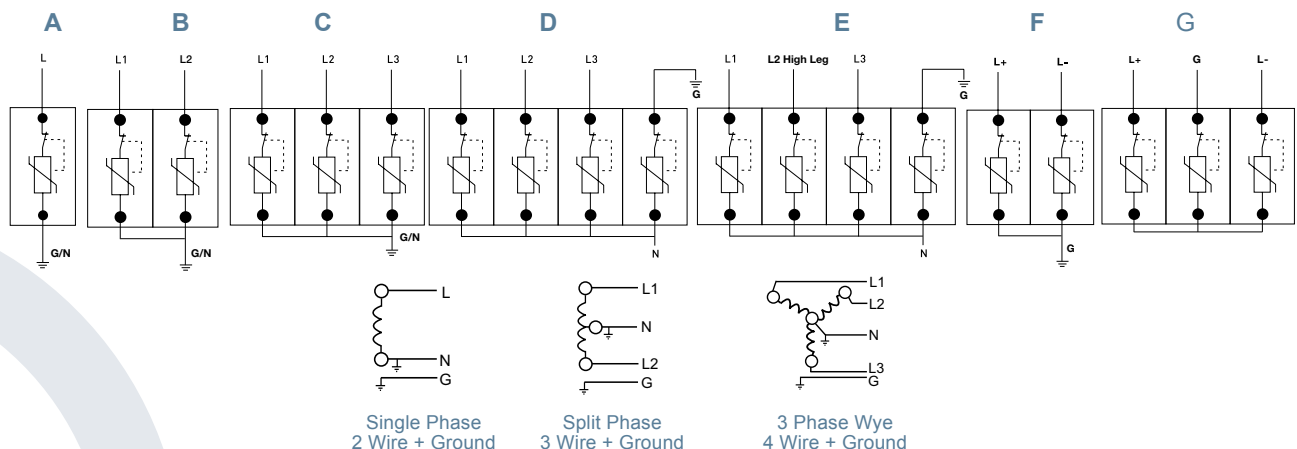

For the most current product performance data visit ep-us.mersen.com and use catalog search.