

PVC-Coated Conduit and Accessories

The ultimate in corrosion protection!

Ocal-Blue® Conduit

- Hot-dip galvanized steel or aluminum conduit
- Nominal .002" (2 mil) blue urethane coating on interior
- Hot-dipped galvanized threads (steel)
- Minimum .040" (40 mil) PVC coating on exterior — in your choice of blue, white, gray or custom colors
- Color-coded thread protectors
- Couplings shipped with conduit are packaged separately



CAT. NO.		PIPE SIZE IN. METRIC SIZE DESIGNATOR*	OUTSIDE DIAMETER STEEL ONLY IN. MM	OUTSIDE DIAMETER WITH PVC IN. MM	NOMINAL WALL THICKNESS STEEL ONLY IN. MM	NOMINAL WALL THICKNESS WITH PVC IN. MM	NOMINAL INSIDE DIAMETER IN. MM	CROSS SECTION AREA IN SQUARE IN. MM	LENGTH WITHOUT COUPLINGS FT. M	MINIMUM WEIGHT PER FOOT STEEL ONLY LBS. KG
STEEL	ALUMINUM									
COND1/2-	COND1/2SA-	½	.84	.92	.10	.14	.63	.30	9'11¼"	.79
		16	21.30	23.30	2.64	3.56	16.10	7.72	3.03	.36
COND3/4-	COND3/4SA-	¾	1.05	1.13	.11	.15	.84	.53	9'11¼"	1.05
		21	26.70	28.70	2.71	3.73	21.20	13.53	3.03	.48
COND1-	COND1SA-	1	1.32	1.40	.13	.17	1.06	.86	9'11"	1.53
		27	33.40	35.40	3.20	4.21	27.00	21.94	3.02	.69
COND1-1/4-	COND1-1/4SA-	1¼	1.66	1.74	.13	.17	1.39	1.50	9'11"	2.01
		35	42.20	44.10	3.37	4.39	35.40	37.97	3.02	.91
COND1-1/2-	COND1-1/2SA-	1½	1.90	1.98	.14	.18	1.62	2.04	9'11"	2.40
		41	48.30	50.20	3.50	4.52	41.20	51.71	3.02	1.09
COND2-	COND2SA-	2	2.38	2.46	.15	.19	2.08	3.36	9'11"	3.32
		53	60.30	62.30	3.70	4.72	52.90	85.21	3.02	1.51
COND2-1/2-	COND2-1/2SA-	2½	2.88	2.96	.19	.23	2.49	4.80	9'10½"	5.27
		63	73.00	75.00	4.90	5.91	63.20	121.61	3.01	2.39
COND3-	COND3SA-	3	3.50	3.58	.21	.25	3.09	7.39	9'10½"	6.83
		78	88.90	90.90	5.20	6.22	78.50	187.80	3.01	3.10
COND3-1/2-	COND3-1/2SA-	3½	4.00	4.08	.22	.26	3.57	9.87	9'10¼"	8.31
		91	101.60	103.60	5.46	6.47	90.70	250.60	3.00	3.77
COND4-	COND4SA-	4	4.50	4.58	.23	.27	4.05	12.73	9'10¼"	9.73
		103	114.30	116.30	5.71	6.73	102.90	323.34	3.00	4.41
COND5-	COND5SA-	5	5.56	5.64	.25	.29	5.07	20.01	9'10"	13.14
		129	141.30	143.30	6.22	7.23	128.90	508.15	3.00	5.96
COND6-	COND6SA-	6	6.63	6.71	.27	.31	6.09	28.89	9'10"	17.46
		155	168.30	170.30	6.75	7.87	154.80	733.83	3.00	7.92

Note — Inches, feet and pounds are indicated in bold type. Metric measure is directly below bold type.
* Metric size designator (ANSI C80.1-1994).

CAT. NO.	SIZE	MATERIAL	COLOR
COND3/4	¾	Blank = Steel	_____ = space for color identifier
		SA = Aluminum	G = Gray
			W = White
			B = Blue

Catalog No. Example:
COND3/4-G is ¾" steel conduit coated in gray PVC.
Custom colors also available.



PVC-Coated Conduit Bodies and Fittings

Ocal-Blue® Conduit Bodies Quick Reference

SHAPE	STYLE	SIZE (IN. AND METRIC SIZE DESIGNATOR*)									
		½" 16	¾" 21	1" 27	1¼" 35	1½" 41	2" 53	2½" 63	3" 78	3½" 91	4" 103
	Form 7	C17-__	C27-__	C37-__	C47-__	C57-__	C67-__	C77-__	C87-__	—	—
	Form 8	C18-4X-__	C28-4X-__	C38-4X-__	C448-4X-__	C58-4X-__	C68-4X-__	C78-__	C88-__	—	—
	Mark 9	C19-__	C29-__	C39-__	C49-__	C59-__	C69-__	C789-__	C889-__	C989-__	C1089-__
	Form 7 Aluminum	C17SA-__	C27SA-__	C37SA-__	C47SA-__	C57SA-__	C67SA-__	C77SA-__	C87SA-__	—	—
	Form 7	LU17-__	LU27-__	LU37-__	LU47-__	LU57-__	LU67-__	—	—	—	—
	Form 8	LU18-4X-__	LU28-4X-__	LU38-4X-__	LU448-4X-__	LU58-4X-__	LU68-4X-__	—	—	—	—
	Form 7	LB17-__	LB27-__	LB37-__	LB47-__	LB57-__	LB67-__	LB777-__	LB87-__	LB97-__	LB107-__
	Form 8	LB18-4X-__	LB28-4X-__	LB38-4X-__	LB448-4X-__	LB58-4X-__	LB68-4X-__	LB78-__	LB888-__	LB98-__	LB108-__
	Mark 9	LB19-__	LB29-__	LB39-__	LB49-__	LB59-__	LB69-__	LB789-__	LB889-__	LB989-__	LB1089-__
	Form 7 Aluminum	LB17SA-__	LB27SA-__	LB37SA-__	LB47SA-__	LB57SA-__	LB67SA-__	LB777SA-__	LB87SA-__	LB97SA-__	LB107SA-__
	Form 7	LL17-__	LL27-__	LL37-__	LL47-__	LL57-__	LL67-__	LL777-__	LL87-__	LL97-__	LL107-__
	Form 8	LL18-4X-__	LL28-4X-__	LL38-4X-__	LL448-4X-__	LL58-4X-__	LL68-4X-__	LL78-__	LL888-__	—	—
	Mark 9	LL19-__	LL29-__	LL39-__	LL49-__	LL59-__	LL69-__	LL789-__	LL889-__	LL989-__	LL1089-__
	Form 7 Aluminum	LL17SA-__	LL27SA-__	LL37SA-__	LL47SA-__	LL57SA-__	LL67SA-__	LL777SA-__	LL87SA-__	LL97SA-__	LL107SA-__
	Form 7	LR17-__	LR27-__	LR37-__	LR47-__	LR57-__	LR67-__	LR777-__	LR87-__	LR97-__	LR107-__
	Form 8	LR18-4X-__	LR28-4X-__	LR38-4X-__	LR448-4X-__	LR58-4X-__	LR68-4X-__	LR78-__	LR888-__	—	—
	Mark 9	LR19-__	LR29-__	LR39-__	LR49-__	LR59-__	LR69-__	LR789-__	LR889-__	LR989-__	LR1089-__
	Form 7 Aluminum	LR17SA-__	LR27SA-__	LR37SA-__	LR47SA-__	LR57SA-__	LR67SA-__	LR777SA-__	LR87SA-__	LR97SA-__	LR107SA-__
	Form 7	T17-__	T27-__	T37-__	T47-__	T57-__	T67-__	T77-__	T87-__	T97-__	T107-__
	Form 8	T18-4X-__	T28-4X-__	T38-4X-__	T448-4X-__	T58-4X-__	T68-4X-__	T78-__	T88-__	—	—
	Mark 9	T19-__	T29-__	T39-__	T49-__	T59-__	T69-__	T789-__	T889-__	T989-__	T1089-__
	Form 7 Aluminum	T17SA-__	T27SA-__	T37SA-__	T47SA-__	T57SA-__	T67SA-__	T77SA-__	T87SA-__	T97SA-__	T107SA-__
	Form 7	TB17-__	TB27-__	TB37-__	TB47-__	TB57-__	TB67-__	—	—	—	—
	Form 8	TB18-4X-__	TB28-4X-__	TB38-4X-__	TB448-4X-__	TB58-4X-__	TB68-4X-__	—	—	—	—
	Mark 9	TB19-__	TB29-__	TB39-__	TB49-__	—	—	—	—	—	—
	Form 7 Aluminum	TB17SA-__	TB27SA-__	TB37SA-__	TB47SA-__	TB57SA-__	TB67SA-__	—	—	—	—
	Form 7	X17-__	X27-__	X37-__	X47-__	X57-__	X67-__	—	—	—	—
	Form 8	X18-4X-__	X28-4X-__	X38-4X-__	X448-4X-__	X58-4X-__	X68-4X-__	—	—	—	—
	Mark 9	X19-__	X29-__	X39-__	—	—	—	—	—	—	—
	Form 7 Aluminum	X17SA-__	X27SA-__	X37SA-__	X47SA-__	X57SA-__	X67SA-__	—	—	—	—

Ocal-Blue® Conduit Body Covers

STYLE	SIZE (IN. AND METRIC SIZE DESIGNATOR*)										
	½" 16	¾" 21	1" 27	1¼" 35	1½" 41	2" 53	2½" 63	3" 78	3½" 91	4" 103	
	Form 7	170F-__	270F-__	370F-__	470F-__	570F-__	670F-__	870F-__	870F-__	970F-__	970F-__
	Form 8	180F-4X-__	280F-4X-__	380F-4X-__	480F-4X-__	580F-4X-__	680F-4X-__	880F-__	880F-__	980F-__	980F-__
	Mark 9	190-__	290-__	390-__	490-__	590-__	690-__	889-__	889-__	989-__	989-__
	Form 7 Aluminum	170SA-__	270SA-__	370SA-__	470SA-__	570SA-__	670SA-__	870SA-__	870SA-__	970SA-__	970SA-__

* Metric size designator (ANSI C80.1-1994).

PVC-Coated Conduit Bodies and Fittings

TB

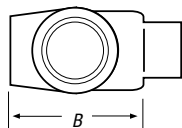

TB Form 7 Ferrous Conduit Bodies with Covers

CAT. NO.	HUB SIZE*	DIMENSIONS (IN. AND MM)**					VOL. CAP. (CU.IN./CU.CM)
		A	B	C	D	E	
TB17-	½"	5.60	2.06	1.63	.95	3.20	6.00
	16	142.24	52.32	41.40	24.13	81.28	98.32
TB27-	¾"	6.20	2.31	1.81	1.15	3.80	9.10
	21	157.48	58.67	45.97	29.21	96.52	149.12
TB37-	1"	7.35	2.50	2.31	1.35	4.55	16.90
	27	186.69	63.50	58.67	34.29	115.57	276.94
TB47-	1¼"	7.30	3.19	2.25	1.80	5.00	19.30
	35	185.42	81.03	57.15	45.72	127.00	316.27
TB57-	1½"	8.60	3.91	2.42	2.05	5.45	27.50
	41	218.44	99.31	61.47	52.07	138.43	450.64
TB67-	2"	9.50	4.50	3.06	2.45	6.40	52.80
	53	241.30	114.30	77.72	62.23	162.56	865.24

TB Form 8 Ferrous Conduit Bodies with Covers

CAT. NO.	HUB SIZE*	DIMENSIONS (IN. AND MM)**					VOL. CAP. (CU.IN./CU.CM)
		A	B	C	D	E	
TB18-4X-	½"	5.69	2.63	1.38	1.00	3.31	6.00
	16	144.46	66.68	34.93	25.40	84.14	98.32
TB28-4X-	¾"	6.28	2.88	1.19	1.19	3.94	9.00
	21	159.54	73.03	30.16	30.16	100.01	147.48
TB38-4X-	1"	7.31	3.25	1.75	1.38	4.56	15.00
	27	185.74	82.55	44.45	34.93	115.89	245.81
TB448-4X-	1¼"	8.50	3.31	2.19	1.75	5.31	24.00
	35	215.90	84.14	55.56	44.45	134.94	393.29
TB58-4X-	1½"	10.38	3.69	2.75	2.13	6.50	46.50
	41	263.53	93.66	69.85	53.98	165.10	762.00
TB68-4X-	2"	12.25	4.25	3.75	3.00	8.56	88.00
	53	311.15	107.95	95.25	76.20	217.49	1442.06

* Metric size designator (ANSI C80.1-1994).

** Dimensions shown are for uncoated conduit bodies.

LU

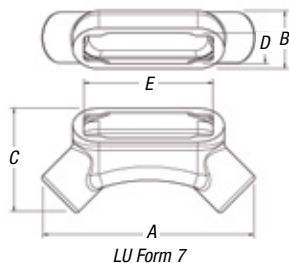

LU Form 7

TB Mark 9 Aluminum Conduit Bodies with Covers

CAT. NO.	HUB SIZE*	DIMENSIONS (IN. AND MM)**					VOL. CAP. (CU.IN./CU.CM)
		A	B	C	D	E	
TB19-	½"	5.00	2.13	1.38	1.19	3.31	—
	16	127.00	53.98	34.93	30.16	84.14	—
TB29-	¾"	5.69	2.41	1.56	1.38	3.94	—
	21	144.46	61.12	39.69	34.93	100.01	—
TB39-	1"	6.59	2.84	1.75	1.50	4.56	—
	27	167.48	72.23	44.45	38.10	115.89	—
TB49-	1¼"	7.50	3.47	2.19	1.94	5.31	—
	35	190.50	88.11	55.56	49.21	134.94	—

TB Form 7 Aluminum Conduit Bodies with Covers

CAT. NO.	HUB SIZE*	DIMENSIONS (IN. AND MM)**					VOL. CAP. (CU.IN./CU.CM)
		A	B	C	D	E	
TB17SA-	½"	5.60	2.06	1.63	.95	3.20	6.00
	16	142.24	52.32	41.40	24.13	81.28	98.32
TB27SA-	¾"	6.20	2.31	1.81	1.15	3.80	9.10
	21	157.48	58.67	45.97	29.21	96.52	149.12
TB37SA-	1"	7.35	2.50	2.31	1.35	4.55	16.90
	27	186.69	63.50	58.67	34.29	115.57	276.94
TB47SA-	1¼"	7.30	3.19	2.25	1.80	5.00	19.30
	35	185.42	81.03	57.15	45.72	127.00	316.27
TB57SA-	1½"	8.60	3.91	2.42	2.05	5.45	27.50
	41	218.44	99.31	61.47	52.07	138.43	450.64
TB67SA-	2"	9.50	4.50	3.06	2.45	6.40	52.80
	53	241.30	114.30	77.72	62.23	162.56	865.24

LU Form 7 Ferrous Conduit Bodies with Covers

CAT. NO.	HUB SIZE	DIMENSIONS (IN.)					CU. IN.
		A	B	C	D	E	
LU17-	½"	5.54	1.45	2.72	.95	3.20	4.8
LU27-	¾"	6.22	1.70	3.07	1.15	3.80	7.6
LU37-	1"	7.34	1.97	3.52	1.35	4.55	13.4
LU47-	1¼"	8.40	2.47	4.21	1.80	5.00	23.0
LU57-	1½"	8.95	2.72	4.44	2.05	5.45	28.3
LU67-	2"	10.61	3.43	5.43	2.45	6.40	56.0

* Metric size designator (ANSI C80.1-1994).

** Dimensions shown are for uncoated conduit bodies.