

Dual-Rated Mechanical Connectors

Type ADR-ALCÜL™ — Three Conductors, Two-Hole Mount*

- For copper and aluminum conductors
- Easy installation – no special tools required
- Tin-plated for low contact resistance
- CSA Certified and UL Listed
- All aluminum bodies

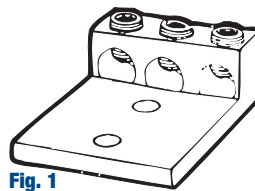
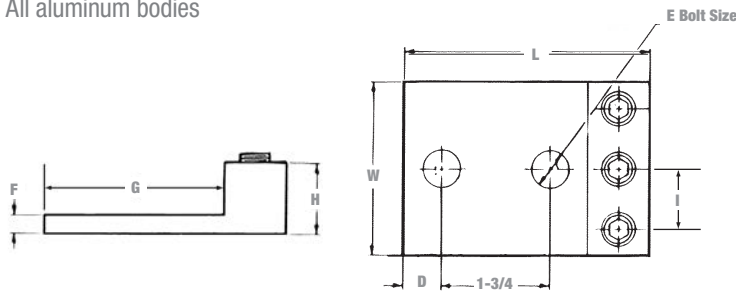

Fig. 1

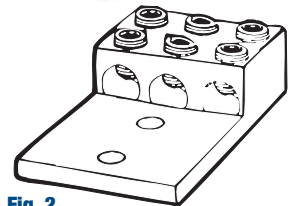

Fig. 2



Cat. No.	Fig. No.	Conductor Range		Dimensions (in.)							
		Max.	Min.	L	W	H	D	E	F	G	I
ADR02-32	1	2 str.	14 AWG	2-3/16	1-5/8	5/8	11/32	5/16	3/16	1-11/16	9/16
ADR11-32		1/0 str.		2-29/32	2	7/8		3/8	1/4	2-5/32	45/64
ADR31-32		3/0 str.	6 str.	4	2-13/16	1-3/16	5/8	1/2	5/16	3	31/32
ADR25-32		250 kcmil		4-3/16					3-3/16	1-1/4	1/4
ADR35-32		350 kcmil		4 str.	4-11/16	3-3/4			1-9/16	7/16	3-5/16
ADR50-32		2	500 kcmil	2 str.	5-5/16	4-3/16	1-1/2	3/8	3-1/6	3-1/6	1-7/16
ADR60-32D			600 kcmil		300 kcmil	6-3/16	4-1/2				1-7/8
ADR80-32	800 kcmil		500 kcmil	6-3/16	4-3/4	1-7/8	9/16	3-7/16	1-41/64		
ADR99-32	1000 kcmil										

* NEMA Spacing: 1-3/4 in. centers except ADR02-32; 7/8 in. centers and ADR11-32; 1 in. centers. Connectors accommodating conductors 600 kcmil and larger have double row of set screws (D suffix).