

Disconnects and Male Tabs

250 Series — Female Disconnects (continued)

7 Non-insulated 90° flag



7

CAT. NO.	PKG. QTY.	WIRE RANGE	MAX. INS.	TAB SIZE	FIG.	REC. TOOL	DIMENSIONS	
							A	B
A18-250A	50	22-18	—	.250 x .032	3	ERG4002	.58	.61
A252G	500	22-18	—	.250 x .032	3		.58	.61
B14-250A	50	16-14	—	.250 x .032	3	ERG4002	.58	.62
B252G	500	16-14	—	.250 x .032	3		.58	.62
C10-250A	50	12-10	—	.250 x .032	3	ERG4005	.64	.63
C252G	500	12-10	—	.250 x .032	3		.64	.63

250 Series — Nylon Piggy Back Disconnects

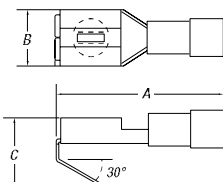

CAT. NO.	PKG. QTY.	WIRE RANGE	MAX. INS.	TAB SIZE	REC. TOOL	DIMENSIONS		
						A	B	C
RA18-250FP	100	22-18	.136	.250 x .032	WT112M	.87	.30	.43
RA250P	1,000	22-18	.136	.250 x .032		.87	.30	.43
RB14-250FP	100	16-14	.163	.250 x .032	ERG4001	.87	.30	.43
RB250P	1,000	16-14	.163	.250 x .032		.87	.30	.43

187 Series — Female Disconnects

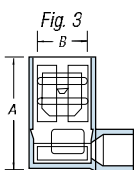
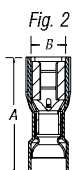

1

1 Nylon self-insulated

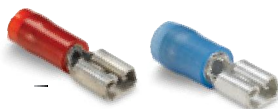

2 Vinyl self-insulated



3 Nylon fully insulated



4 Non-insulated



5 Nylon fully insulated 90° flag



5

CAT. NO.	PKG. QTY.	WIRE RANGE	MAX. INS.	TAB SIZE	FIG.	REC. TOOL	DIMENSIONS		
							A	B	
RAD18-183	100	22-18	.136	.187 x .032	1	ERG4001	.83	.23	
RAD1833	1,000	22-18	.136	.187 x .032	1		.83	.23	
RAD18-182	100	22-18	.136	.187 x .020	1		.83	.23	
RAD1823	1,000	22-18	.136	.187 x .020	1		.83	.23	
RBD14-183	100	16-14	.163	.187 x .032	1		.83	.23	
RBD1833	1,000	16-14	.163	.187 x .032	1		.83	.23	
RBD14-182	100	16-14	.163	.187 x .020	1		.83	.23	
RBD1823	1,000	16-14	.163	.187 x .020	1		.83	.23	
18RAD-183	100	22-18	.150	.187 x .032	1		ERG4001	.85	.23
RAD1837	1,000	22-18	.150	.187 x .032	1			.85	.23
18RAD-182	100	22-18	.150	.187 x .020	1			.85	.23
RAD1827	1,000	22-18	.150	.187 x .020	1			.85	.23
14RBD-183	100	16-14	.170	.187 x .032	1	.85		.23	
RBD1837	1,000	16-14	.170	.187 x .032	1	.85		.23	
14RBD-182	100	16-14	.170	.187 x .020	1	.85	.23		
RBD1827	1,000	16-14	.170	.187 x .020	1	.85	.23		
18RAD-18377	100	22-18	.150	.187 x .032	2	ERG4001	.89	.30	
RAD18377	1,000	22-18	.150	.187 x .032	2		.89	.30	
18RAD-18277	100	22-18	.150	.187 x .020	2		.89	.30	
RAD18277	1,000	22-18	.150	.187 x .020	2		.89	.30	
14RBD-18377	100	16-14	.170	.187 x .032	2		.89	.30	
RBD18377	1,000	16-14	.170	.187 x .032	2		.89	.30	
14RBD-18277	100	16-14	.170	.187 x .020	2	.89	.30		
RBD18277	1,000	16-14	.170	.187 x .020	2	.89	.30		
AD18-183	100	22-18	—	.187 x .032	1	ERG4002	.64	.23	
AD183	1,000	22-18	—	.187 x .032	1		.64	.23	
AD18-182	100	22-18	—	.187 x .020	1		.64	.23	
AD182	1,000	22-18	—	.187 x .020	1		.64	.23	
BD14-183	100	16-14	—	.187 x .032	1		.64	.23	
BD183	1,000	16-14	—	.187 x .032	1		.64	.23	
BD14-182	100	16-14	—	.187 x .020	1	.64	.23		
RAD18-187A	50	22-18	.150	.187 x .032	3	ERG4001	.74	.59	
RAD1877F	500	22-18	.150	.187 x .032	3		.74	.59	
RAD18-188A	50	22-18	.150	.187 x .020	3		.74	.59	
RAD1887F	500	22-18	.150	.187 x .020	3		.74	.59	
RBD14-187A	50	16-14	.170	.187 x .032	3		.74	.61	
RBD1877F	500	16-14	.170	.187 x .032	3		.74	.61	
RBD14-188A	50	16-14	.170	.187 x .020	3		.74	.61	
RBD1887F	500	16-14	.170	.187 x .020	3		.74	.61	

UL Listed E66716