

## Technical Information

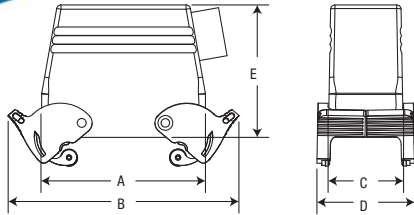

**Mounting Dimensions for Double Lever Hoods  
(Reverse Locking)**

Cat. No.	Housing Series				Dimensions are in inches (millimeters)				
	A, B, t, k	c, v	D	DD	A	B	C	D	E
LH_32A	A32		D50		3.23 (82)	5.04 (128)	2.21 (56)	2.76 (70)	2.99 (76)
LH_10E	B10, T10	V3		DD42	2.87 (73)	4.33 (110)	1.69 (43)	2.28 (58)	1.89 (48)
LH_10EH___					2.87 (73)	4.33 (110)	1.69 (43)	2.28 (58)	2.84 (72)
LH_16E	B16, T16	C6, V6	D40	DD72	3.70 (94)	5.16 (131)	1.69 (43)	2.28 (58)	2.56 (65)
LH_16EH					3.70 (94)	5.16 (131)	1.69 (43)	2.28 (58)	2.99 (76)
LH_24E	B24, T24, K12	V10, V16	D64	DD108	4.72 (120)	6.18 (157)	1.69 (43)	2.28 (58)	2.99 (76)

### Dust Covers for Housings



Housing Series				For Single-Lever Housings	For Double-Lever Housings	For Single-Post Housings	For Double-Post Housings
A, B, T, K	C, V	D	DD				
A3, A4		D7, D8		DCL103A-1			
A10		D15		DCL110A-1		DCS110A-1	
A16		D25		DCL116A-1		DCS116A-1	
A32		D50			DCL232A-1/DCL432A-1*		DCS232A-1
B6, T6**			DD24	DCL106B-1			
B10, T10**	V3		DD42	DCL110B-1	DCL210B-1/DCL410B-1*		
B16, T16**	C6, V6	D40	DD72	DCL116B-1	DCL216B-1/DCL416B-1*		
B24, T24**, K12	V10, V16	D64	DD108	DCL124B-1	DCL224B-1/DCL424B-1*		

\* Comes with gasket for hoods with levers and without gaskets

\*\* Dust covers tested only to 125°C (if applied to 200°C Series T)

### Gaskets

Cat. No.		Housing Series			
Panel Base, Flat	Molded Edge Contour*	A, B, T, K	C, V	D	DD
A04XFGP	A04XMEC	A3, A4		D7, D8	
A10XFGP	A10XMEC	A10		D15	
A16XFGP	A16XMEC	A16		D25	
A32XFGP	A32XMEC	A32		D50	
B6XFGP	B6XMEC	B6, T6**			DD24
B10XFGP	B10XMEC	B10, T10**	V3		DD42
B16XFGP	B16XMEC	B16, T16**	V6, C6	D40	DD72
B24XFGP	B24XMEC	B24, T24**, K12	V10, V16	D64	DD108
B32XFGP	B32XMEC	B32	C12	D80	DD144
B48XFGP	B48XMEC	B48, K24	V20, V26, V32	D128	DD216

\* Install with silicone sealant/adhesive for industrial use

\*\* For T Series 200°C applications, specify catalogue number except use "T" prefix instead of "B" for gaskets. EX: use "T16XFGP" for panel base gaskets.