

Fittings and Brackets

Angular Fittings

AB225

AB225HDGC
AB225EG
AB225
AB225SS6

Wt./C 58 lb.

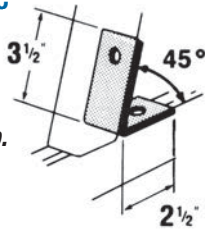

Other angles available.
Contact your Regional Sales Office.

AB226

AB226HDGC
AB226SS6

Wt./C 119 lb.

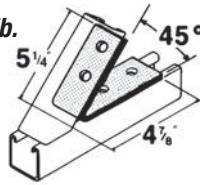

Other angles available.
Contact your Regional Sales Office.

AB227

AB227HDGC
AB227EG
AB227
AB227SS6

Wt./C 58 lb.

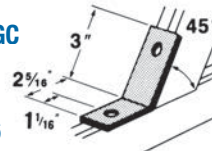

Other angles available.
Contact your Regional Sales Office.

AB228

AB228HDGC
AB228SS6C

Wt./C 69 lb.

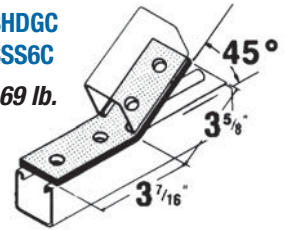

Other angles available.
Contact your Regional Sales Office.

AB231

AB231EG

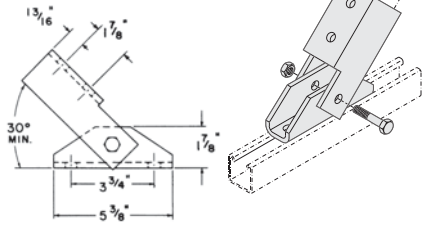

AB232

AB232EG

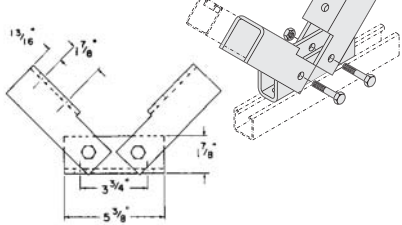

AB239

*Finishes

• HDGC • EG • GoldGalv®

Cat. No.	A (in.)	B (in.)	Wt./C lb.
AB239-1*	7-13/16	8-1/2	148
AB239-2*	13-3/4	17	255
AB239-3*	19-3/4	25-1/2	363

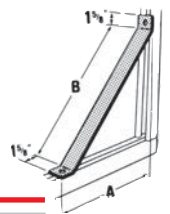

"Z" Shape Fittings

A209

A209HDGC
A209EG
A209
A209SS6

Wt./C 55 lb.

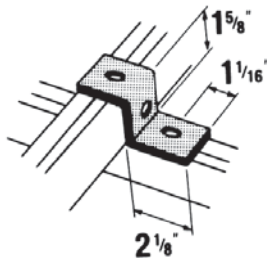

For attaching A and AR Series channel.

B209

B209HDGC
B209EG
B209

Wt./C 43 lb.

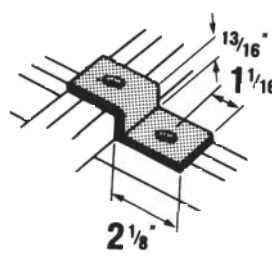

For attaching B and BR Series channel.

C209

C209

Wt./C 49 lb.

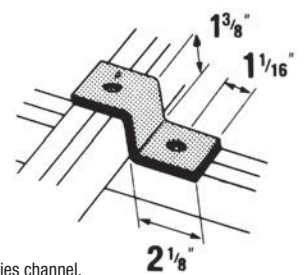

For attaching C Series channel.

D209

Wt./C 45 lb.

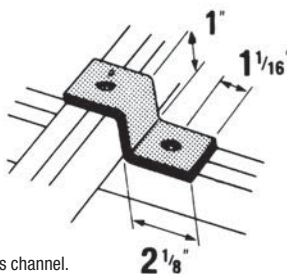

For attaching D Series channel.

CZ209

For attaching H Series
and A back to back.

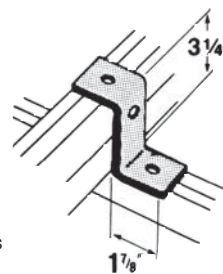

EZ209

EZ209HDGC
EZ209EG
EZ209
EZ209SS6

For attaching E Series channel.

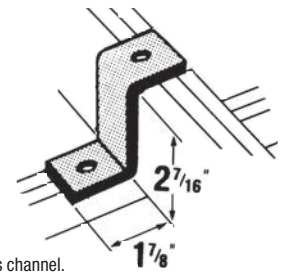

Standard Dimensions	Value
Hole Spacing	→ 13/16 in. From End
Hole Spacing	→ 1-7/8 in. Centers
Hole Size	→ 9/16 in. Diam.
Material	→ 1-5/8 in. Width
Material	→ 1/4 in. Thick

Materials	Value
HDG(C)	→ Hot-Dipped Galvanized
EG(C)	→ Electrogalvanized
(No suffix)	→ GoldGalv®
SS6(C)	→ Stainless Steel 316