

Flag Terminals

Non-Insulated Flags

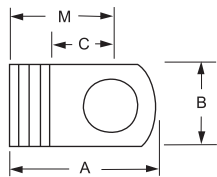
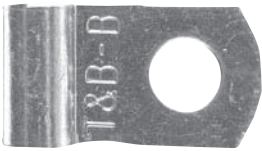

Cat. No.	Pkg. Qty.	Wire Range	Bolt Hole	Rec. Tool	Dimensions (in.)				Stock Thick. (in.)
					A	B	C	M	
AB14-6A	100	22-14	#6	ERG4004	0.55	0.31	0.22	0.39	0.03
AB51	1,000		#6						
AB14-8A	100		#8						
AB52	1,000		#8						
AB14-10A	100		#10						
AB53	1,000	#10							
C51	500	12-10	#6		0.66		0.25	0.48	0.04
C10-8A	50		#8						
C52-TB	500		#8						
C10-10A	50		#10						
C53	500		#10						
D236	200	8	#10	WT129	0.83	0.50	0.29	0.64	0.06
D226			#10		0.90				
D271			1/4 in.		0.92				
E226		#10	0.93		0.29		0.69		
E271		1/4 in.	0.99						
E272		5/16 in.	1.05						
F226		#10	1.07		0.33		0.80		
F271		1/4 in.	1.10						
F272		5/16 in.	1.18						
F273		3/8 in.	1.20		0.43		0.90		
G671	1/4 in.	1.20							
G672	5/16 in.	1.28							
G673	3/8 in.	1.32	0.46	1.02					
H672	5/16 in.	1.31							
H673	3/8 in.	1.36							
J672	5/16 in.	1.46	0.41	1.10					
J673	3/8 in.	1.51							
J675	1/2 in.	1.67							
K672	5/16 in.	1.59	0.41	1.19					
K673	3/8 in.	1.64							
K675	1/2 in.	1.76							
M673	3/8 in.	1.89	0.46	1.43					
M675	1/2 in.	1.99							
		250kcmil	3/8 in.		1.89	1.0	0.46	1.43	0.13
			1/2 in.		1.99	1.0	0.55	1.52	0.13