

Armoured Cable and Flexible Metal Conduit Fittings

Two-Screw Fittings

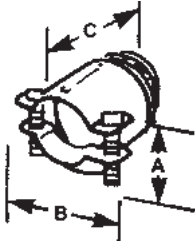

Cat. No.	Cable Opening (in.)		Trade Size (in.)	K.O. Size (in.)	Dimensions (in.)		
	max.	min.			A	B	C
3301-C*	0.656	0.250	3/8	1/2	5/8	1-5/16	1-3/16
3312-C	0.937	0.500	1/2	1/2	5/8	1-5/16	1-3/16

* UL Listed for armoured cable only.

Formed steel body with carefully round bushing. The armour gripping saddle stays open by itself when cable is being inserted.

Duplex Clamp Fitting



Cat. No.	K.O. Size (in.)	Dimensions (in.)	
		A	B
291-C	1/2	1-13/32	1-11/16

UL Listed as grounding means under NEC 350-5.

Malleable iron.

For nonmetallic and armoured cable.

Adaptor—EMT to Flex

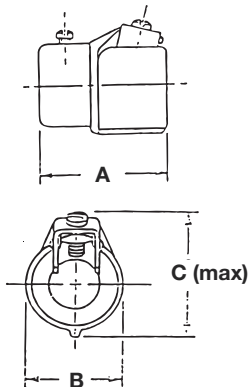

Cat. No.	K.O. Size (in.)	Dimensions (in.)		
		A	B	C
503-TB	1/2 - 1/2	1-21/32	1-3/16	1-7/8
504	3/4 - 3/4	1-25/32	1-7/16	2-1/8
505-TB	1 - 1	2-1/32	2-1/16	2-5/8

Tite-Bite® fitting design holds flexible metal cable firmly in place with a single screw rather than two screws.