

Dragon Tooth® Magnet Wire Termination System

Connectors for every application!

Fork Terminals

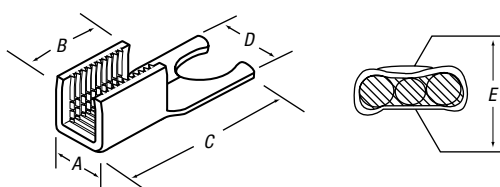
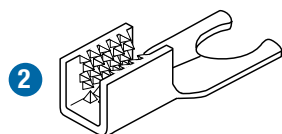
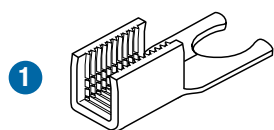

CAT. NO.	STUD SIZE	DIMENSIONS (IN.)					CIRCULAR MIL AREA	ROUND WIRE RANGE (AWG)	RECTANGULAR WIRE RANGE (IN.)		PKG. QTY.
		A	B	C	D	E*			THICKNESS	WIDTH	
22F061**	6	.16	.32	.78	.30	.10	404-4100	15-24	.02-.05	.02-.10	1000
22F081**	8	.16	.32	.78	.30	.10	404-4100	15-24	.02-.05	.02-.10	1000
22F101**	10	.16	.32	.78	.30	.10	404-4100	15-24	.02-.05	.02-.10	1000
22F066	6	.25	.45	.91	.30	.13	2,580-12,330	12-16	.05-.08	.05-.16	1000
22F086	8	.25	.45	.91	.30	.13	2,580-12,330	12-16	.05-.08	.05-.16	1000
22F106	10	.25	.45	.91	.30	.13	2,580-12,330	12-16	.05-.08	.05-.16	1000
210219F	6	.25	.45	.91	.30	.13	2,580-12,330	12-16	.05-.08	.05-.16	1000
210217F	8	.25	.45	.91	.30	.13	2,580-12,330	12-16	.05-.08	.05-.16	1000
210216F	10	.25	.45	.91	.30	.13	2,580-12,330	12-16	.05-.08	.05-.16	1000

* Reference dimension. See installing die illustration for gauging.

** #22-#24 AWG and equivalent rectangular CMA, copper only.

Durable and convenient!

Disconnects

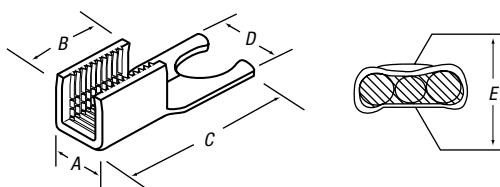
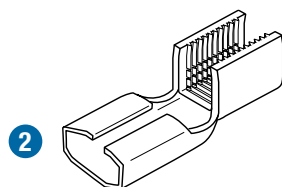
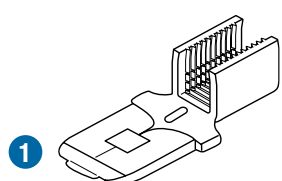

CAT. NO.	TAB SIZE	DIMENSIONS (IN.)					CIRCULAR MIL AREA	ROUND WIRE RANGE (AWG)	RECTANGULAR WIRE RANGE (IN.)		PKG. QTY.
		A	B	C	D	E*			THICKNESS	WIDTH	
22LM01**	.250 x .032	.16	.32	.76	.25	.10	404-4100	15-24	.02-.05	.02-.10	1000
22LM06	.250 x .032	.25	.45	.91	.25	.13	2,580-12,330	12-16	.05-.08	.05-.16	1000
22LF01**	.250 x .032	.16	.32	.79	.25	.10	404-4100	15-24	.02-.05	.02-.10	1000
22LF06	.250 x .032	.25	.45	.91	.25	.13	2,580-12,330	12-16	.05-.08	.05-.16	1000

* Reference dimension. See installing die illustration for gauging.

Note: Wire sizes and combinations shown have been tested to and meet or exceed Thomas & Betts specifications. Connectors may be suitable for other wire sizes or combinations. Thomas & Betts sells these connectors with the understanding that the user will perform necessary tests to determine their suitability for the intended purpose.

** #22-#24 AWG and equivalent rectangular CMA, copper only.