

Dragon Tooth® Magnet Wire Termination System

Secure connections easily! Ring Terminals

Wire Termination — Sta-Kon® Wire Termination & Insulation

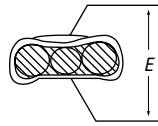
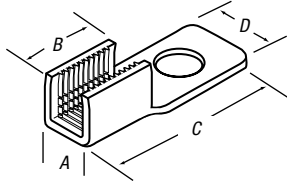
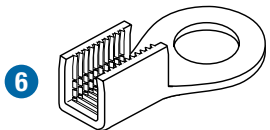
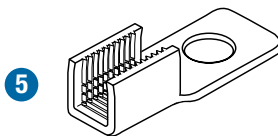
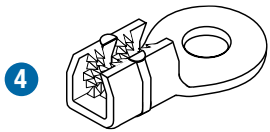
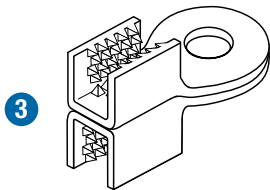
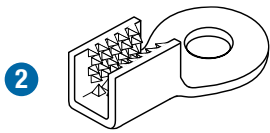
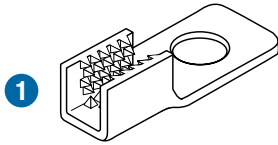

CAT. NO.	STUD SIZE	DIMENSIONS (IN.)					CIRCULAR MIL AREA	ROUND WIRE RANGE (AWG)	RECTANGULAR WIRE RANGE (IN.)		PKG. QTY.	
		A	B	C	D	E*			THICKNESS	WIDTH		
1	314125	10	.38	.56	1.22	.41	.14	3,260–12,330	15–13	.05–.06	.05–.18	250
	314123	¼"	.38	.56	1.41	.41	.14	3,260–12,330	15–13	.05–.06	.05–.18	250
	210219	8	.38	.56	1.22	.41	.17	4,110–20,760	14(a)–10	.08–.09	.08–.18	250
1	210217	10	.38	.56	1.22	.41	.17	4,110–20,760	14(a)–10	.08–.09	.08–.18	250
	210216	¼"	.38	.56	1.41	.41	.17	4,110–20,760	14(a)–10	.08–.09	.08–.18	250
1	204217	10	.53	.61	1.58	.50	.25	10,380–52,480	12(b)–4(c)	.10–.16	.10–.26	100
	204212	¼"	.53	.61	1.58	.50	.25	10,380–52,480	12(b)–4(c)	.10–.16	.10–.26	100
	210214-1	¼"	.38	.56	1.41	.69	.17	4,110–20,760	14(a)–10	.08–.09	.08–.18	250
2	210214-2	⅝"	.38	.56	1.41	.69	.17	4,110–20,760	14(a)–10	.08–.09	.08–.18	250
	210214-3	⅜"	.38	.56	1.41	.69	.17	4,110–20,760	14(a)–10	.08–.09	.08–.18	250
	204210-1	¼"	.53	.61	1.58	.81	.25	10,380–52,480	12(b)–4(c)	.10–.16	.10–.26	100
2	204210-2	⅝"	.53	.61	1.58	.81	.25	10,380–52,480	12(b)–4(c)	.10–.16	.10–.26	100
	204210-3	⅜"	.53	.61	1.58	.81	.25	10,380–52,480	12(b)–4(c)	.10–.16	.10–.26	100
	204210-5	½"	.53	.61	1.58	.81	.25	10,380–52,480	12(b)–4(c)	.10–.16	.10–.26	100
3	204210-1H	¼"	.53	.61	1.58	.81	.47	20,760–104,960	12(b)–4(c)	.10–.16	.10–.26	100
	204210-3H	⅜"	.53	.61	1.58	.81	.47	20,760–104,960	12(b)–4(c)	.10–.16	.10–.26	100
	220017	⅜"	.88	1.50	2.76	1.06	(d)	50,000–115,000	.100–.175	—	.300–.625	25
	220018	½"	.88	1.50	2.76	1.06	(d)	50,000–115,000	.100–.175	—	.300–.625	25
4	220021	⅝"	.88	1.50	2.76	1.06	(d)	110,000–175,000	—	.175–.250	.300–.625	25
	220022	½"	.88	1.50	2.76	1.06	(d)	110,000–175,000	—	.175–.250	.300–.625	25
	220025	⅜"	.88	1.50	2.76	1.06	(d)	110,000–230,000	—	.175–.325	.300–.625	25
	220026	½"	.88	1.50	2.76	1.06	(d)	110,000–230,000	—	.175–.325	.300–.625	25
	22R061**	6	.16	.32	.78	.30	.10	404–4100	15–24	.02–.05	.02–.10	1000
5	22R081**	8	.16	.32	.78	.30	.10	404–4100	15–24	.02–.05	.02–.10	1000
	22R101**	10	.16	.32	.78	.30	.10	404–4100	15–24	.02–.05	.02–.10	1000
	22R086	8	.25	.45	.91	.30	.13	2,580–12,330	12–16	.05–.08	.05–.16	1000
5	22R106	10	.25	.45	.91	.30	.13	2,580–12,330	12–16	.05–.08	.05–.16	1000
6	22R146	¼"	.25	.45	.95	.42	.13	2,580–12,330	12–16	.05–.08	.05–.16	1000

* Reference dimension. See installing die illustration for gauging. (a) Four wires max. (b) Six wires max. (c) Conductors heavier than #6 AWG require special dies. Contact Thomas & Betts for assistance. (d) Crimping dies may not bottom. Connector height will depend on number and size of wires in barrel. Pump must deliver 9800 psi minimum.

Note: Wire sizes and combinations shown have been tested to and meet or exceed Thomas & Betts specifications. Connectors may be suitable for other wire sizes or combinations. Thomas & Betts sells these connectors with the understanding that the user will perform necessary tests to determine their suitability for the intended purpose.

** #22–#24 AWG and equivalent rectangular CMA, copper only.