









of Contacts + Ground Connection

Bases — Standard Mount				3 + G + 2 Control		6 + G + 2 Control	
SINGLE LEVER	DOUBLE LEVER	HOUSING	NPT ENTRY	LEVER LOCKING TYPE			
				SINGLE	DOUBLE	SINGLE	DOUBLE
		Panel Base		PB303V	PB103EV	PB306V	PB106EV
		w/Cover		PB403V	—	PB406V	—
		Box Base (no Cover)	1 X 1/2"	BB403V	BB003EV	—	—
			1 X 3/4"	—	—	BB406V	BB006EV
		Box Base w/Cover	2 X 1/2"	BB503V	BB103EV	—	—
			1 X 1/2"	BB603V*	—	BB506V	BB106EV
			1 X 3/4"	—	—	BB606V*	—
			2 X 1/2"	BB703V*	—	BB706V*	—
			2 X 3/4"	—	—	BB706V*	—



Hoods — Standard Mount

		Side Entry	1 X 1/2"	SH603V	SH003V	—	—
			1 X 3/4"	—	—	SH606V	SH006V
		Top Entry	1 X 1/2"	TH803V	TH203V	—	—
			1 X 3/4"	—	—	TH806V	TH206V



Coupler Hoods — Inline *For Inline, Portable or Special Service Connections. Coupler Hoods mate to Standard Hoods ONLY.*

		Top Entry	1 X 1/2"	CH803V	CH603EV	—	—
			1 X 3/4"	—	—	CH806V	CH606EV

Lever Hoods — Reverse Locking *Lever Hoods mate to Post Bases ONLY.*

	Side Entry w/Lever(s)	1 X 3/4"		LH003EV		LH006EV
	Top Entry w/Lever(s)	1 X 3/4"		LH203EV		LH206EV

Bases — with Access Cover *Post Bases accept Lever Hoods ONLY.*

	Panel Base+ Posts w/Cover		—	PB203V*	—	PB206V*
	Box Base+ Posts w/Cover	1 X 1/2"	—	BB303V*	—	—
		1 X 3/4"	—	—	—	BB206V*
		2 X 1/2"	—	BB203V*	—	—
		2 X 3/4"	—	—	—	BB306V*

* Add "M" final suffix for metal cover option.

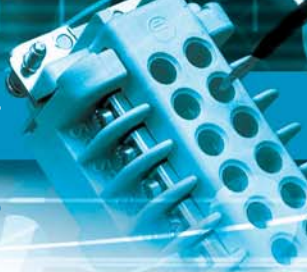

Mounting Dimensions for Double Lever Panel Bases

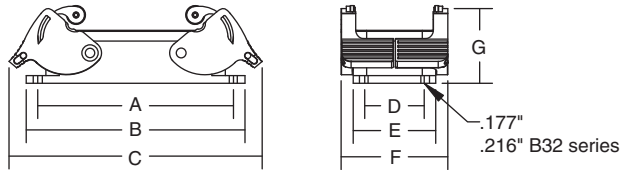

HOUSING SERIES				CAT. NO.	DIMENSIONS ARE IN INCHES / (MILLIMETRES)						
A, B, T, K	C, V	D	DD		A	B	C	D	E	F	G
A32	D50			PB132A	3.62 / (92)	4.02 / (102)	5.04 / (128)	1.65 / (28)	2.24 / (57)	2.76 / (70)	1.10 / (28)
B10, T10	V3		DD42	PB110E	3.27 / (83)	3.66 / (93)	4.33 / (110)	1.26 / (32)	1.69 / (43)	2.28 / (58)	1.06 / (27)
B16, T16	C6, V6	D40	DD72	PB116E	4.05 / (103)	4.49 / (114)	5.16 / (131)	1.26 / (32)	1.69 / (43)	2.28 / (58)	1.06 / (27)
B24, T24,	V10, V16	D64	DD108	PB124E	5.12 / (130)	5.51 / (140)	6.19 / (157)	1.26 / (32)	1.69 / (43)	2.28 / (58)	1.06 / (27)
B32	C12	D80	DD144	PB132E	4.33 / (110)	4.88 / (124)	5.28 / (134)	2.56 / (65)	3.11 / (79)	3.62 / (92)	1.18 / (30)

Mounting Dimensions for Single Lever Panel Bases

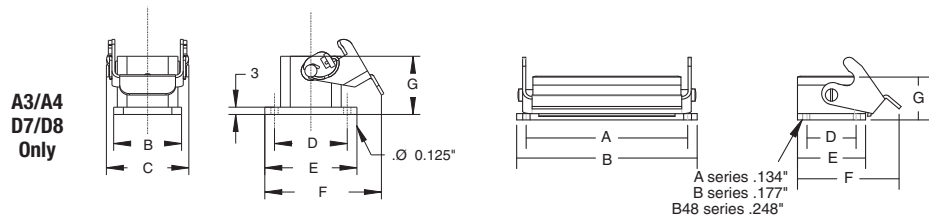

HOUSING SERIES				CAT. NO.	DIMENSIONS ARE IN INCHES / (MILLIMETRES)						
A, B, T, K	C, V	D	DD		A	B	C	D	E	F	G
A3, A4		D7, D8		PB303A (P)*	—	1.10 / (28)	1.34 / (34)	1.18 / (30)	1.50 / (38)	1.67 / (42.5)	.95 / (24)
				PB403A (P)*	—	1.10 / (28)	1.38 / (35)	1.18 / (30)	1.58 / (40)	1.85 / (47)	.95 / (24)
				PB503A (P)	1.10 / (28)	1.59 / (40.5)	1.00 / (25.5)	1.42 / (36)	1.18 / (30)	1.50 / (38)	
A10		D15		PB310A	2.76 / (70)	3.19 / (81)	—	.68 / (17.5)	1.20 / (30.5)	1.93 / (49)	1.02 / (26)
A16		D25		PB410A	2.76 / (70)	3.19 / (81)	—	.68 / (17.5)	1.20 / (30.5)	2.95 / (75)	1.02 / (26)
				PB316A	3.39 / (86)	3.78 / (96)	—	.68 / (17.5)	1.20 / (30.5)	1.93 / (49)	1.02 / (26)
B6, T6			DD24	PB416A	3.39 / (86)	3.78 / (96)	—	.68 / (17.5)	1.20 / (30.5)	2.95 / (75)	1.02 / (26)
				PB306	2.76 / (70)	3.15 / (80)	—	1.26 / (32)	1.69 / (43)	2.56 / (65)	1.06 / (27)
B10, T10	V3		DD42	PB406	2.76 / (70)	3.15 / (80)	—	1.26 / (32)	1.69 / (43)	3.54 / (90)	1.06 / (27)
				PB310	3.27 / (83)	3.66 / (93)	—	1.26 / (32)	1.69 / (43)	2.64 / (67)	1.06 / (27)
B16, T16	C6, V6	D40	DD72	PB410	3.27 / (83)	3.66 / (93)	—	1.26 / (32)	1.69 / (43)	3.62 / (92)	1.06 / (27)
				PB316	4.06 / (103)	4.49 / (114)	—	1.26 / (32)	1.69 / (43)	2.64 / (67)	1.06 / (27)
B24, T24,	V10, V16	D64	DD108	PB416	4.06 / (103)	4.49 / (114)	—	1.26 / (32)	1.69 / (43)	3.62 / (92)	1.06 / (27)
				PB324	5.12 / (130)	5.51 / (140)	—	1.26 / (32)	1.69 / (43)	2.64 / (67)	1.06 / (27)
B48, K24,	V20, V26	D128	DD216	PB424	5.12 / (130)	5.51 / (140)	—	1.26 / (32)	1.69 / (43)	3.62 / (92)	1.06 / (27)
				PB348	5.83 / (148)	6.50 / (165)	—	2.76 / (70)	3.54 / (90)	6.18 / (157)	1.61 / (41)
V32				PB448	5.83 / (148)	6.50 / (165)	—	2.76 / (70)	3.54 / (90)	6.81 / (173)	1.61 / (41)

*Suffix: A - Aluminum, P - Plastic