

Shield-Kon®

Insulated Two-Piece Grounding Connectors, Dies and Tool for the Hexagonal Range

Nylon-insulated Shield-Kon® connectors for added insulation protection.

Shield-Kon® Grounding Connectors

Insulated Connector Outer Sleeve

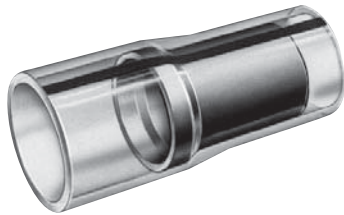

Insulated Outer Sleeve — Cat. GSR

- Use with GSB inner sleeves
- Soft bronze outer sleeve with nylon insulation over the braided groundwire

CAT. NO.	COLOR CODE	I.D.	O.D.	TOOLS		MILITARY SPEC. NO.	STD. PKG.
				DIE NOS. FOR WT440/WT540*	DIE NOS. FOR 11901A		
Insulated							
GSR101	Gray	.101	.124	4400	11970	18121-101	500
GSR128	Blue	.128	.152	4401	11971	18121-128	500
GSR149	Purple	.149	.179	4403	11973	18121-149	500
GSR156	Yellow	.156	.193	4406	11976	18121-156	500
GSR175	Blue	.175	.215	4408	11978	18121-175	500
GSR187	Orange	.187	.227	4410	11980	18121-187	500
GSR194	Red	.194	.226	4410	11980	18121-194	500
GSR199	Gray	.199	.235	4410	11980	18121-199	500
GSR205	Yellow	.205	.245	4411	11981	18121-205	500
GSR219	Green	.219	.250	4411	11981	18121-219	500
GSR225	Purple	.225	.256	4411	11981	18121-225	500
GSR232	Orange	.232	.263	4412	11982	18121-232	500
GSR261	Yellow	.261	.297	4414	11984	18121-261	500
GSR275	Gray	.275	.306	4415	11985	18121-275	500
GSR281	Purple	.281	.331	4417	11987	18121-281	500
GSR287	Blue	.287	.327	4417	11987	18121-287	500
GSR297	Green	.297	.335	4417	11987	18121-297	500
GSR312	Yellow	.312	.362	5451	—	18121-312	100
GSR327	Gray	.327	.372	5452	11988	18121-327	100
GSR348	Orange	.348	.393	5452	11988	18121-348	100
GSR359	Purple	.359	.399	5452	—	18121-359	100
GSR375	Yellow	.375	.406	5453	—	18121-375	100
GSR405	Red	.405	.453	5455	—	18121-405	100
GSR415	Blue	.415	.463	5455	—	18121-415	100
GSR460	Gray	.460	.510	5458	—	18121-460	100
GSR500	Green	.500	.550	5459	—	18121-500	100

*Dies 4400 to 4417 are for WT440. Dies 5451 to 5459 are for WT540

Order multiple is standard package

WT440 and WT540 Ratchet Hand Tools



- Parallel-action hand tools
- MIL-specified
- Frame, with the option of interchangeable steel dies
- A versatile tool, one frame with a selection of dies covers the whole range of shield diameters in the Hexagonal Range
- ShureStake® mechanism: once pressing has started, the tool can be re-opened only after successful completion of the crimping cycle
- Packaging: wood box containing 1 frame (dies to be ordered separately, see selection chart on page H-11 and above for Die Nos.)

Specifications

WT440

- Length: 8"
- Weight: 1.0 lbs
- Dies: Series 4400

WT540

- Length: 10.4"
- Weight: 1.19 lbs.
- Dies: Series 5450

CAT. NO.	DESCRIPTION	STD PKG.
WT440	Ratchet Hand Tool	1
WT540	Ratchet Hand Tool	1