

Couplings and Accessories

Threaded Erickson® Three-Piece Coupling

(For Threaded Rigid Metal Conduit and Intermediate Metal Conduit)



674 Series
675AL Series

Application

- To couple and effectively bond threaded ends of rigid metal conduit/intermediate metal conduit where neither length of conduit can be rotated

Features

- Malleable iron/steel/copper-free aluminum construction
- Free fitting threads ensure easy assembly
- Permits conduit coupling without rotating either conduit
- Provides rigid in-line coupling with high-quality grounding; will not loosen under vibration
- Suitable for concrete-tight application
- Capable of carrying ground fault currents up to 10,000 amps RMS (1/2" through 1 1/2" size) and up to 20,000 amps RMS (2" and above) (duration of fault current three cycles) (674 series tested)

Standard Material

674 Series

Bushing & Case..... Malleable Iron
Ring..... Steel & Malleable Iron

675AL Series

Bushing & Case..... Aluminum
Ring..... Aluminum

Standard Finish

674 Series: Electro Zinc Plated & Chromate Coated

675AL Series: Degreased

Range

3/8" thru 6" Conduit (malleable iron)
1/2" thru 6" Conduit (aluminum)
All straight pipe threads (NPS)

Listings/Compliances

UL 514B
CSA C22.2 No. 18
NEMA FB1
NFPA 70-1999 (ANSI)
Federal Specification A-A-50553
Federal Standard H-28 (Threads)

With an ERICKSON® coupling, a conduit run may be completed when neither conduit can be turned. A conduit run may also be broken without taking down the whole run. Conduit joined with ERICKSON® Couplings is rigid and in line and vibration will not loosen the connections. Malleable iron.

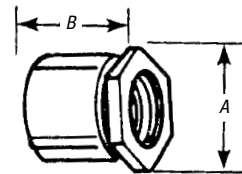

CAT. NO.	ALUM.* CAT. NO.	SIZE	DIMENSIONS (IN.)	
			A	B
674	—	3/8"	1 1/8	1 1/8
675	675AL	1/2"	1 5/32	1 1/4
676	676AL	3/4"	1 9/16	1 3/32
677	677AL	1"	1 29/32	1 5/8
678	678AL	1 1/4"	2 3/8	1 13/16
679	679AL	1 1/2"	2 5/8	1 3/32
680TB	680AL	2"	3 3/32	2 7/32
681	681AL	2 1/2"	3 31/32	2 11/16
682	682AL	3"	4 1/16	2 29/32
683	683AL	3 1/2"	5	3
684	684AL	4"	5 1/2	3 7/16
685	685AL	4 1/2"	6 1/4	3 15/32
686	686AL	5"	6 25/32	3 3/4
687	687AL	6"	8	4 3/32

*Copper-Free Aluminum

UL Listed and CSA Certified concrete-tight.

UL File No. E-23018

CSA File No. 2884

Split Couplings

- Ideal for retrofit installations or in tight areas
- Fast installation
- Neoprene gasket provides a concrete-tight seal
- Joins threaded conduit even when the conduit can't rotate
- Approved for direct burial



T&B's Split Coupling is a simple method to join threaded conduits in retrofits or in snug areas. Available in 1/2" to 6".

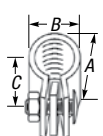

1/2" and 3/4" furnished with one screw

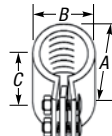

1" and 6" furnished with two screws

Specifications

- Material: Malleable Iron
- Plating: Zinc Plated
- Gasket: Neoprene
- Standards: UL Standard 514B, NEMA FB-1

CAT. NO.	TRADE SIZE	DIMENSIONS (IN.)			WEIGHT PER 100
		A	B	C	
SPCP50	1/2"	2	1 1/4	1 1/4	34.4
SPCP75	3/4"	2 5/16	1 1/2	1 1/4	39.4
SPCP100	1"	2 5/8	1 13/16	1 5/8	60.0
SPCP125	1 1/4"	3 3/16	2 3/16	1 5/8	75.0
SPCP150	1 1/2"	3 5/8	2 7/16	1 15/16	112.5
SPCP200	2"	3 13/16	2 7/8	2	112.5
SPCP250	2 1/2"	4 5/8	3 3/16	3 1/16	275.0
SPCP300	3"	5 5/16	4 1/8	3 3/8	300.0
SPCP350	3 1/2"	6 1/16	4 13/16	3 3/4	425.0
SPCP400	4"	6 5/8	5 3/8	3 11/16	500.0
SPCP500	5"	8 1/16	6 7/16	3 5/8	900.0
SPCP600	6"	9 1/4	7 3/8	4 1/16	1,300.0