

## SNAP<sup>2</sup>IT<sup>®</sup> Duplex Connectors with Insulated Throat



383810AST



404010AST

Zinc die-cast. For AC • MCI-A • HCF steel and aluminum cable • Flexible metal conduit steel and aluminum (regular and reduced wall) • MCI cable • Continuous corrugated aluminum • MC-PCS cable • ACG90 • AC90.

SNAP-TITE<sup>®</sup> and SNAP2IT<sup>®</sup> products have been tested and listed by UL in accordance with UL's ground fault requirements. For additional information see page 7.

| CATALOG NUMBER | UPC/DCI/NAED MFG #018997 | TRADE SIZE | KO SIZE | UNIT PKG | STD PKG | DIM A | DIM B | DIM C | DIM D | CABLE RANGE     |
|----------------|--------------------------|------------|---------|----------|---------|-------|-------|-------|-------|-----------------|
| 383810AST      | 10937                    | 3/8        | 1/2     | 25       | 100     | 2.398 | 2.035 | .840  | .624  | (2) .370 - .490 |
| 404010AST      | 40533                    | 3/8        | 1/2     | 25       | 100     | 2.398 | 2.165 | .840  | .624  | (2) .405 - .612 |
| 505010AST      | 50720                    | 1/2        | 3/4     | 25       | 25      | 3.054 | 2.717 | 1.058 | .810  | (2) .590 - .920 |

Provided with red tinted inside clip so you can tell the difference between a 383810AST & 404010AST.

Refer to chart on page E-27 for a list of cable types. See page E-30 and E-31 for MCI-A cable ranges. Concrete tight when taped.

**PATENTED.**

For the **WIDEST TOTAL CABLE RANGES**

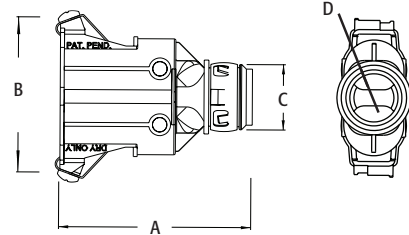

**LISTED SNAP2IT<sup>™</sup> CONNECTORS FOR NEW MC-PCS CABLE**  
Lighting & Low Voltage circuits in the same cable

### INSTALLATION INSTRUCTIONS

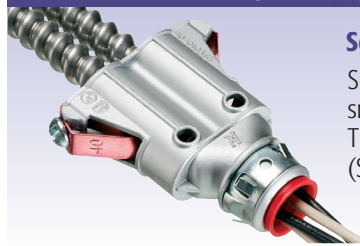

#### Secure hold—Easy cable insertion!

Simply snap the cable into the fitting and snap it into the box...no tools needed! The screw only holds the clip in place. (See page E-1 for ring removal instructions.)

## SNAP<sup>2</sup>IT<sup>®</sup> Duplex Connectors



3838AST



Zinc die-cast. For AC • MCI-A • HCF steel and aluminum cable • Flexible metal conduit steel and aluminum (regular and reduced wall) • MCI cable • Continuous corrugated aluminum • AC90.

SNAP-TITE<sup>®</sup> and SNAP2IT<sup>®</sup> products have been tested and listed by UL in accordance with UL's ground fault requirements. For additional information see page 7.

| CATALOG NUMBER | UPC/DCI/NAED MFG #018997 | TRADE SIZE | KO SIZE | UNIT PKG | STD PKG | DIM A | DIM B | DIM C | DIM D | CABLE RANGE     |
|----------------|--------------------------|------------|---------|----------|---------|-------|-------|-------|-------|-----------------|
| 3838ST         | 10935                    | 3/8        | 1/2     | 25       | 100     | 1.912 | 1.738 | .970  | .620  | (2) .405 - .612 |
| 3838A          | 36200                    | 3/8        | 1/2     | 25       | 100     | 1.772 | 1.738 | .840  | .620  | (2) .405 - 6.12 |
| 3838AST*       | 36230                    | 3/8        | 1/2     | 25       | 100     | 1.772 | 1.605 | .840  | .620  | (2) .405 - .612 |
| 4040AST*       | 40351                    | 3/8        | 1/2     | 25       | 100     | 1.772 | 1.605 | .840  | .620  | (2) .485 - .612 |
| 4040A          | 40350                    | 3/8        | 1/2     | 25       | 100     | 1.772 | 1.605 | .840  | .620  | (2) .485 - .612 |

\*Provided with insulated throat.

Provided with insulated throat and red tinted inside clip. See comparison on page E-1.

Refer to chart on page E-27 for a list of cable types.

See page E-30 and E-31 for MCI-A cable ranges.

Concrete tight when taped.

**PATENTED.**

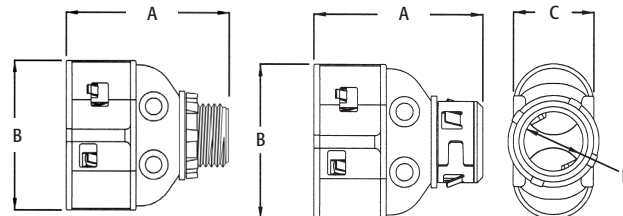

For **EASIER MC/AC Installations** see **383810AST to 404010AST** (above)