

Duplex Connector



Zinc die-cast. Single screw for Flex • AC • MCI • MCI-A • NM cable.

CATALOG NUMBER	UPC/DCI/NAED MFG #018997	TRADE SIZE	KO SIZE	UNIT PKG	STD PKG	DIM A	DIM B	DIM C	DIM D	CABLE RANGE
846	00846	3/8	1/2	25	250	1.542	.437	.888	1.672	.150-.610

Refer to chart on page E-27 for a list of cable types.
See page E-30 and E-31 for MCI-A cable ranges.
Concrete tight when taped.

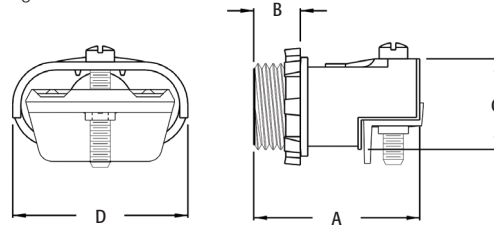

Duplex SNAP-TITE® Connectors



Zinc die-cast. Single screw for Flex • AC • MCI • MCI-A • NM cable.

SNAP-TITE® and SNAP2IT® products have been tested and listed by UL in accordance with UL's ground fault requirements. For additional information see page 7.

(See page E-1 for ring removal instructions.)

CATALOG NUMBER	UPC/DCI/NAED MFG #018997	TRADE SIZE	KO SIZE	UNIT PKG	STD PKG	DIM A	DIM B	DIM C	DIM D	CABLE RANGE
846ST‡	80050	3/8	1/2	25	250	1.635	.510	.888	1.654	.150-.610
846AST*	80052	3/8	1/2	25	250	1.728	.603	.888	1.654	.150-.610

*Provided with insulated throat.

‡Also for MCI-A cable.

Refer to chart on page E-27 for a list of cable types.

See page E-30 and E-31 for MCI-A cable ranges.

Concrete tight when taped.

PATENTED.

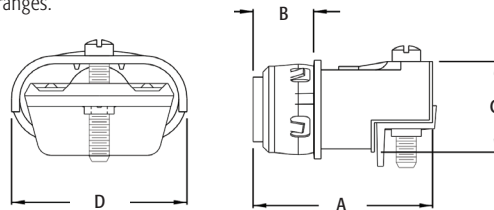

Duplex Connector



Twin screw with steel strap.

Zinc die-cast. For Flex • NM • AC • MCI steel and aluminum jacketed cables.

CATALOG NUMBER	UPC/DCI/NAED MFG #018997	TRADE SIZE	KO SIZE	UNIT PKG	STD PKG	DIM A	DIM B	DIM C	DIM D	CABLE RANGE
846SS	80054	3/8	1/2	25	250	1.562	.437	.888	2.200	.210-.610

Refer to chart on page E-27 for a list of cable types.

Concrete tight when taped.

